

#8 X 2" [M4x.7 x 50] SELF-TAPPING  
SHEET METAL SCREW  
(7 PER FRAME @ 18" [457] O.C.)  
(JK061)

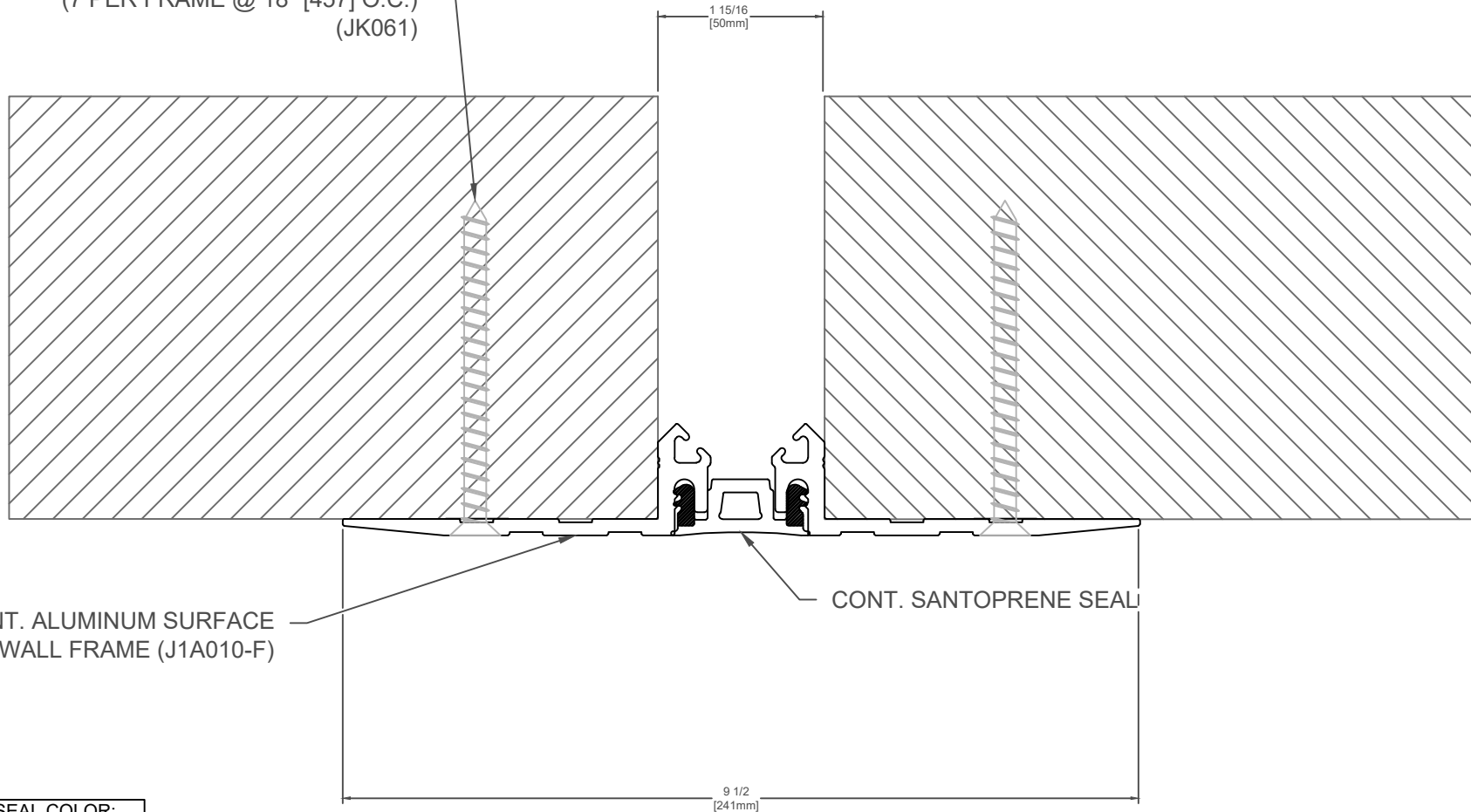

CONT. ALUMINUM SURFACE  
MOUNT WALL FRAME (J1A010-F)

CONT. SANTOPRENE SEAL

## 104-A07-025 SYSTEM

SPECIFY SEAL COLOR:	
Black (J1D101)	
Beige (J1D102)	
Gray (J1D103)	
Off White (J1D104)	
Bright White (J1D105)	
Greige (J1D106)	

JOINT WIDTH		MOVEMENT ±			
		HORIZONTAL		VERTICAL	
US	mm	US	mm	US	mm
1"	25	1/4"	6	1/4"	6

FINISH: ALUMINUM FINISH-204-R1 CLEAR ANODIZED

PROJECT:

CUSTOMER:

LOCATION:

APPLICATION-  
SURFACE MOUNT WALL/WALL -  
CEILING/CEILING CONDITION

DATE: 02-28-17

SCALE: 1:2

DOC: CADJM.065/R3

**inpro.**

For More Information Visit: [Inprocorp.com](http://Inprocorp.com)

#8 X 2" [M4x.7 x 50] SELF-TAPPING SHEET METAL SCREW (7 PER FRAME @ 18" [457] O.C.) (JK061)

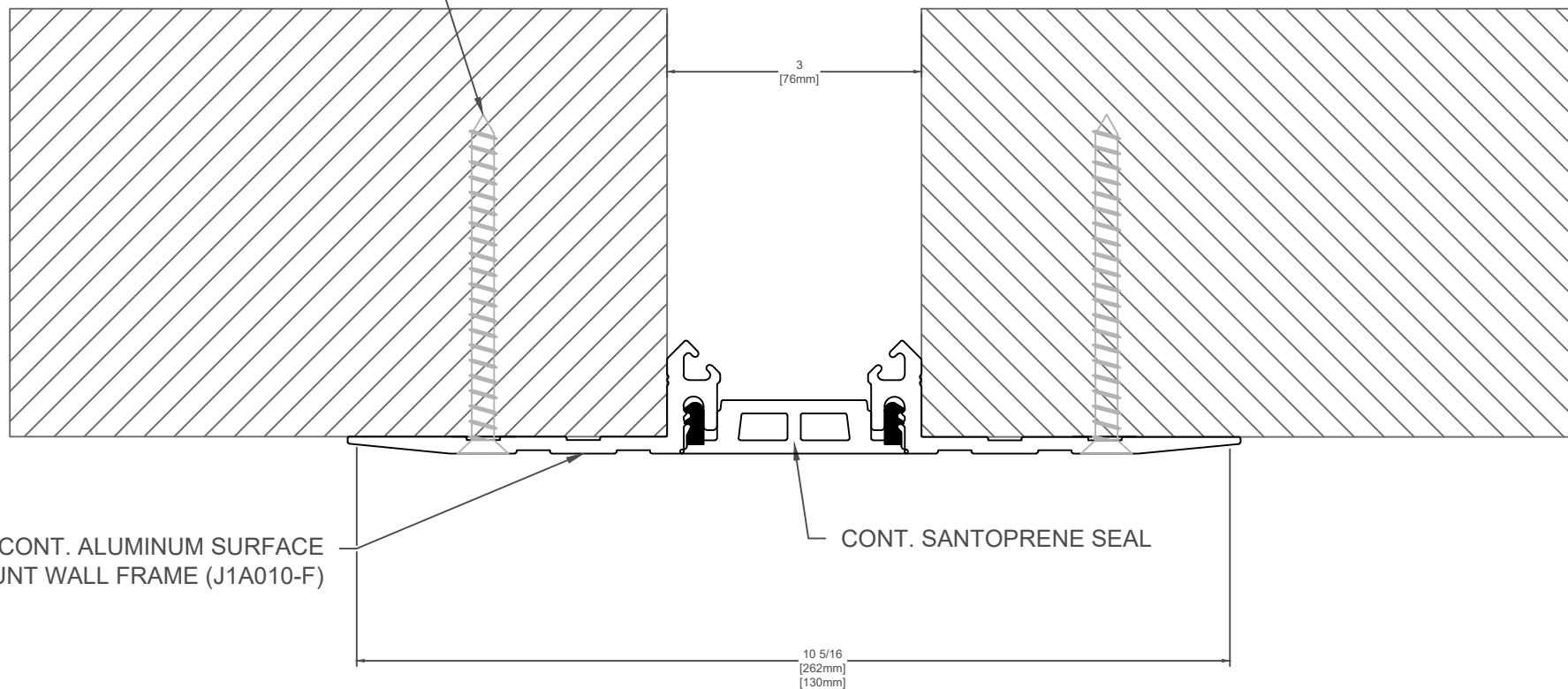

SPECIFY SEAL COLOR:	
Black (J1D151)	<input type="checkbox"/>
Beige (J1D152)	<input type="checkbox"/>
Gray (J1D153)	<input type="checkbox"/>
Off White (J1D154)	<input type="checkbox"/>
Bright White (J1D155)	<input type="checkbox"/>
Greige (J1D156)	<input type="checkbox"/>

## 104-A07-038 SYSTEM

JOINT WIDTH		MOVEMENT ±			
		HORIZONTAL		VERTICAL	
US	mm	US	mm	US	mm
1-1/2"	38	3/8"	10	3/8"	10

FINISH: ALUMINUM FINISH-204-R1 CLEAR ANODIZED

PROJECT:

CUSTOMER:

LOCATION:

APPLICATION-  
SURFACE MOUNT WALL/WALL -  
CEILING/CEILING CONDITION

DATE: 02-28-17

SCALE: 1:2

DOC: CADJM.065/R3

**inpro.**

For More Information Visit: [Inprocorp.com](http://Inprocorp.com)

#8 X 2" [M4x.7 x 50] SELF-TAPPING SHEET METAL SCREW (7 PER FRAME @ 18" [457] O.C.) (JK061)

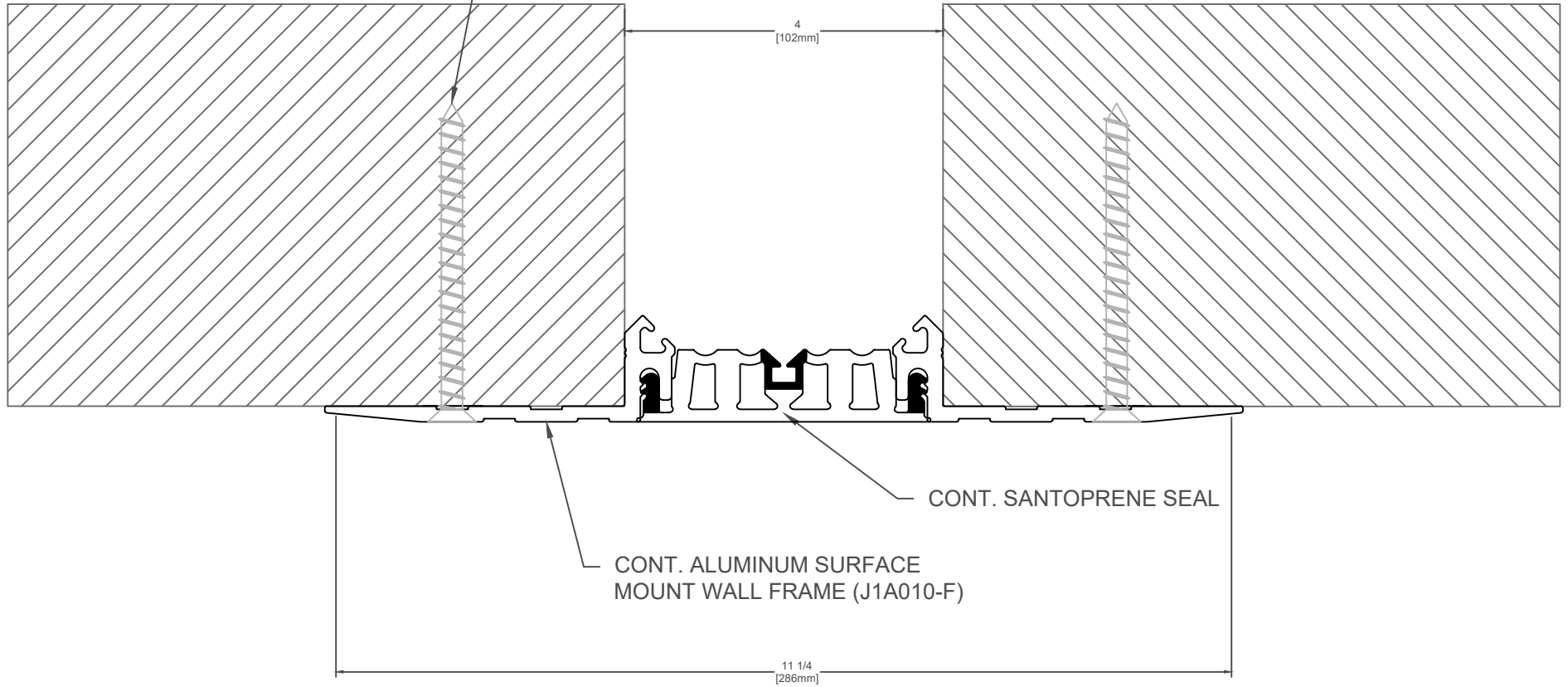

SPECIFY SEAL COLOR:	
Black (J1D201)	
Beige (J1D202)	
Gray (J1D203)	
Off White (J1D204)	
Bright White (J1D205)	
Greige (J1D206)	

## 104-A07-050 SYSTEM

JOINT WIDTH		MOVEMENT ±			
		HORIZONTAL		VERTICAL	
US	mm	US	mm	US	mm
2"	51	1/2"	13	1/2"	13

FINISH: ALUMINUM FINISH-204-R1 CLEAR ANODIZED

PROJECT:

CUSTOMER:

LOCATION:

APPLICATION-  
SURFACE MOUNT WALL/WALL -  
CEILING/CEILING CONDITION

DATE: 02-28-17

SCALE: 1:2

DOC: CADJM.065/R3



For More Information Visit: [Inprocorp.com](http://Inprocorp.com)

#8 X 2" [M4x.7 x 50] SELF-TAPPING SHEET METAL SCREW (7 PER FRAME @ 18" [457] O.C.) (JK061)

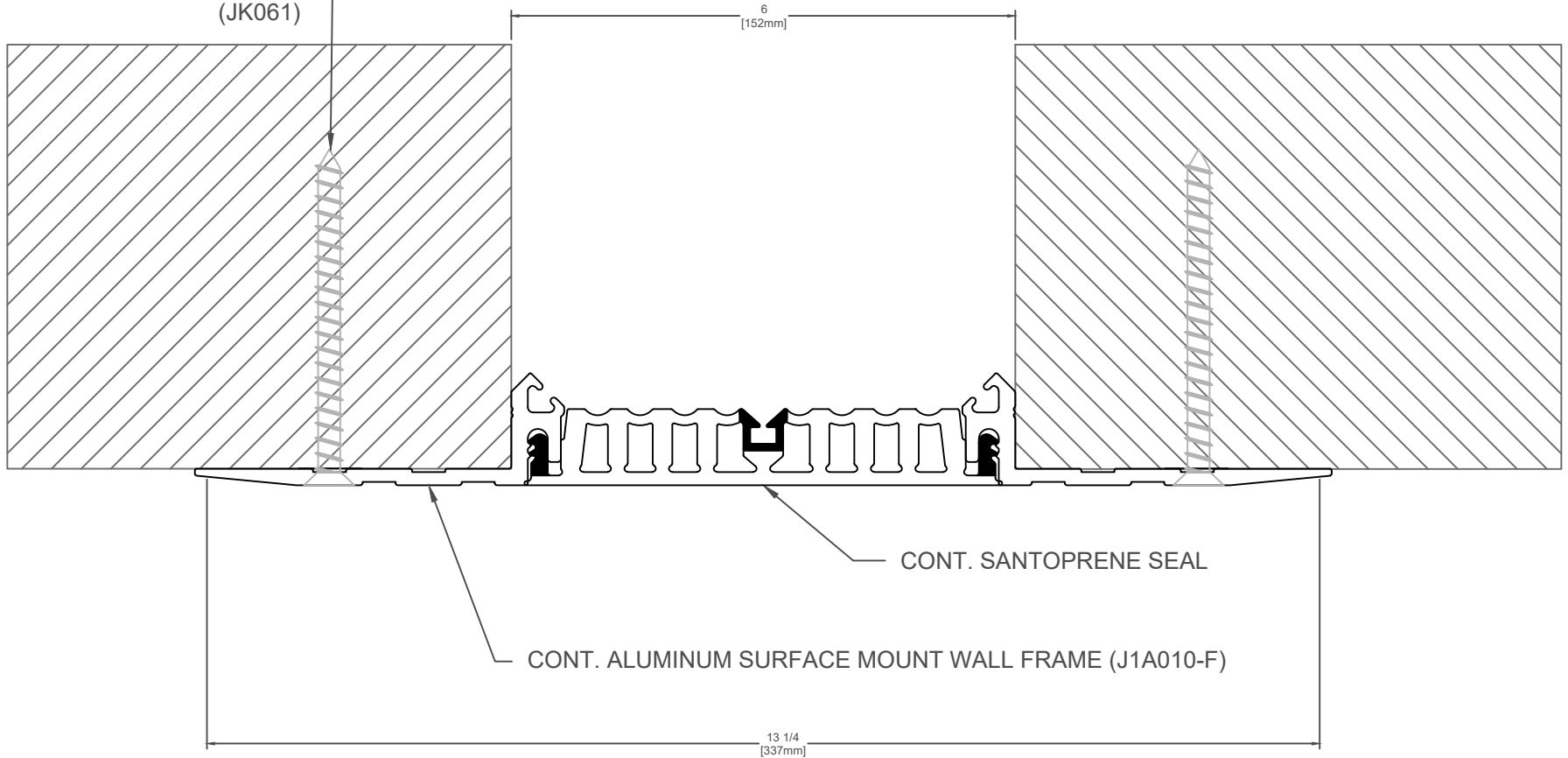

SPECIFY SEAL COLOR:	
Black (J1D301)	
Beige (J1D302)	
Gray (J1D303)	
Off White (J1D304)	
Bright White (J1D305)	
Greige (J1D306)	

## 104-A07-075 SYSTEM

JOINT WIDTH		MOVEMENT ±			
		HORIZONTAL		VERTICAL	
US	mm	US	mm	US	mm
3"	76	3/4"	19	3/4"	19

FINISH: ALUMINUM FINISH-204-R1 CLEAR ANODIZED

PROJECT:  
CUSTOMER:  
LOCATION:

APPLICATION-  
SURFACE MOUNT WALL/WALL -  
CEILING/CEILING CONDITION

DATE: 02-28-17

SCALE: 1:2

DOC: CADJM.065/R3



For More Information Visit: [Inprocorp.com](http://Inprocorp.com)