

491-A07-050

JOINT WIDTH		MOVEMENT ±			
		HORIZONTAL		VERTICAL	
US	mm	US	mm	US	mm
2"	51	9/16"	14	1"	25

FINISH: CLEAR ANODIZED

PROJECT:

CUSTOMER:

LOCATION:

APPLICATION-
CENTERING BAR SYSTEM
SURFACE MOUNT FRAME WALL/WALL, CEILING/CEILING CONDITION

DATE: 9-7-05

SCALE: 1:2

DOC: CADJM.005/R4

inpro.

For More Information Visit: Inprocorp.com

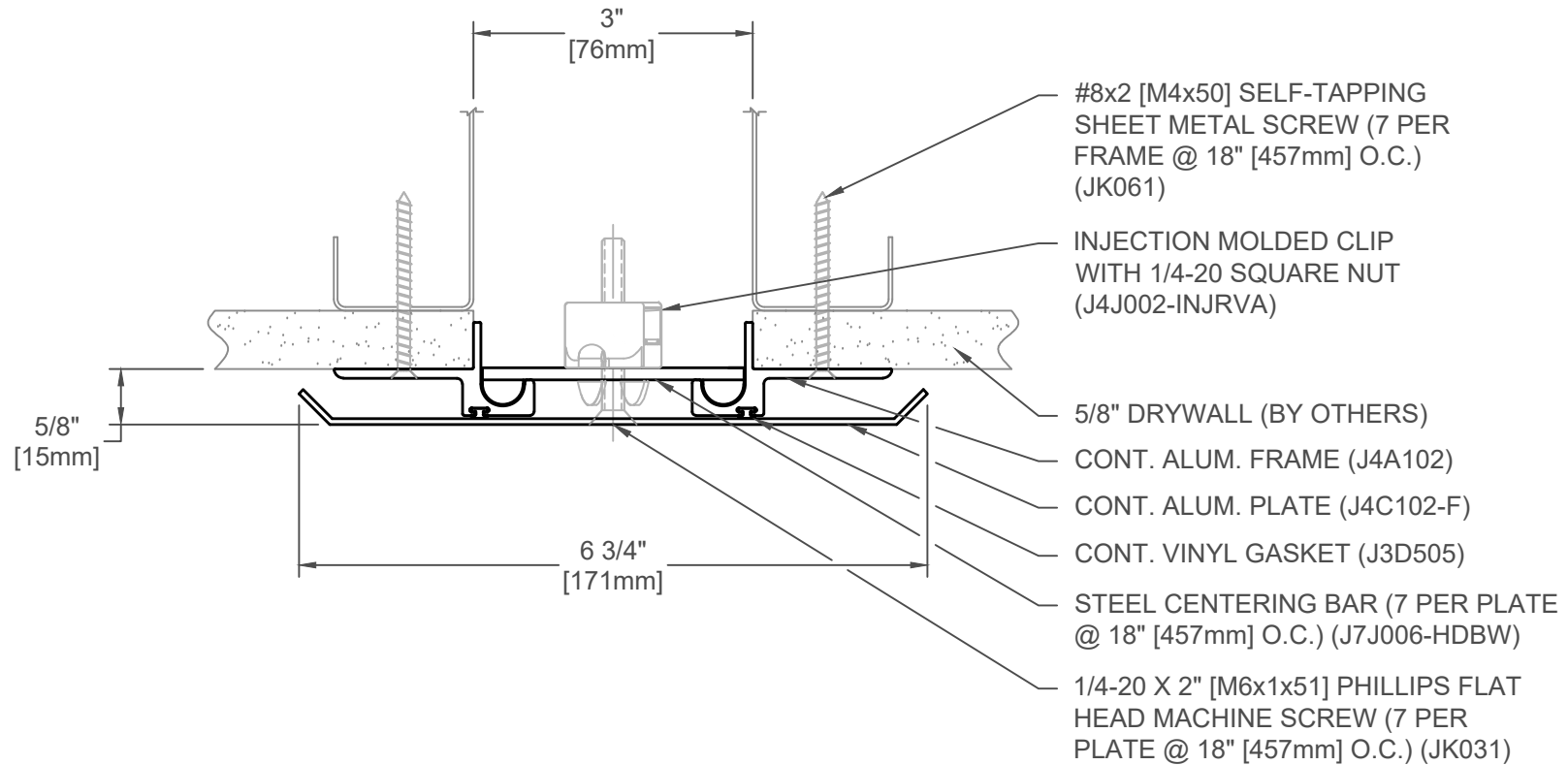

491-A07-075

JOINT WIDTH		MOVEMENT ±			
		HORIZONTAL		VERTICAL	
US	mm	US	mm	US	mm
3"	76	1-1/2"	38	1-1/2"	38

FINISH: CLEAR ANODIZED

PROJECT:

CUSTOMER:

LOCATION:

APPLICATION-
CENTERING BAR SYSTEM
SURFACE MOUNT FRAME WALL/WALL, CEILING/CEILING CONDITION

DATE: 9-7-05

SCALE: 1:2

DOC: CADJM.005/R4

inpro.

For More Information Visit: Inprocorp.com

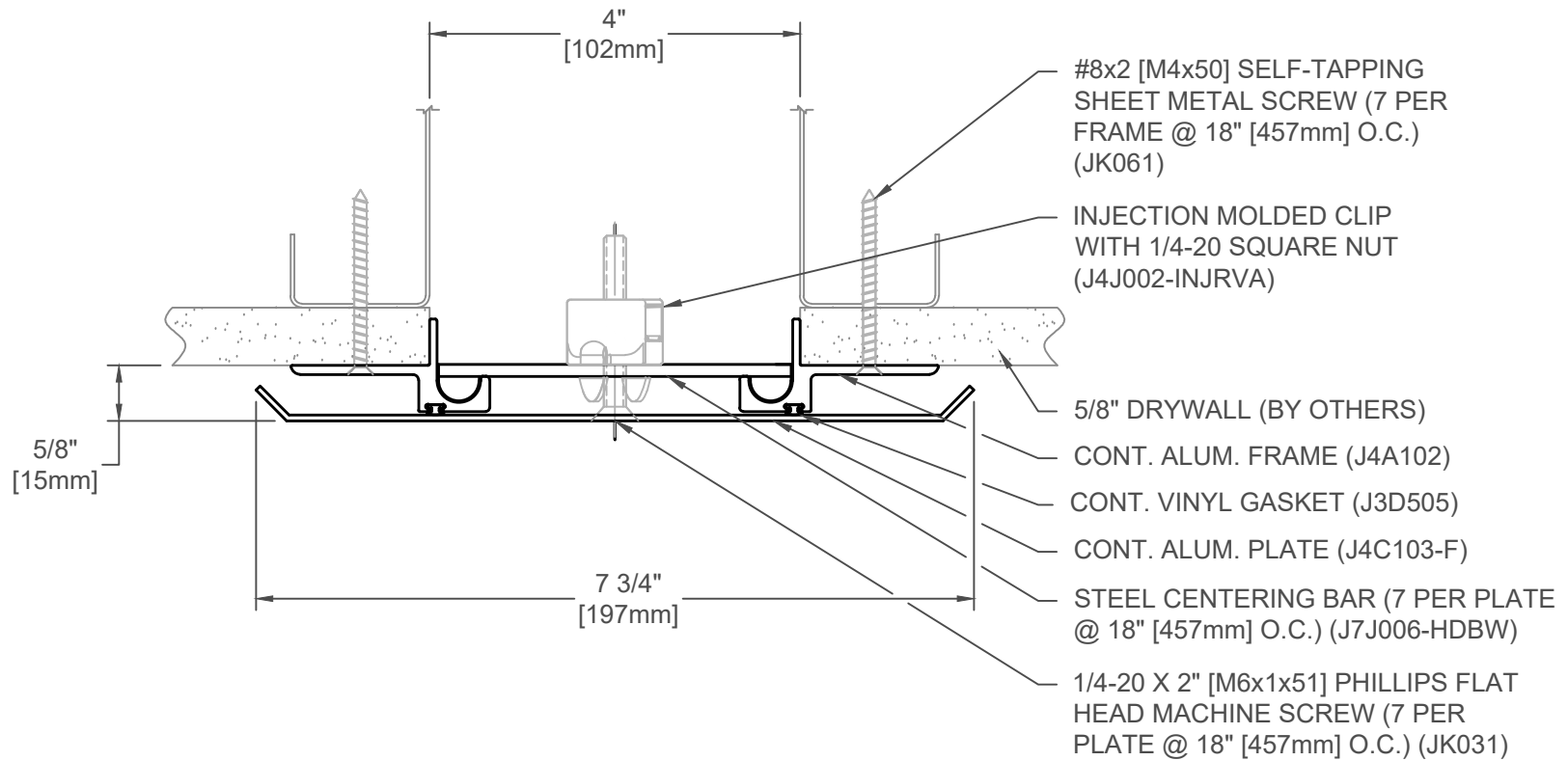

491-A07-100

JOINT WIDTH		MOVEMENT ±			
		HORIZONTAL		VERTICAL	
US	mm	US	mm	US	mm
4"	102	2"	51	2"	51

FINISH: CLEAR ANODIZED

PROJECT:

CUSTOMER:

LOCATION:

APPLICATION-
CENTERING BAR SYSTEM
SURFACE MOUNT FRAME WALL/WALL, CEILING/CEILING CONDITION

DATE: 9-7-05

SCALE: 1:2

DOC: CADJM.005/R4

inpro.

For More Information Visit: Inprocorp.com

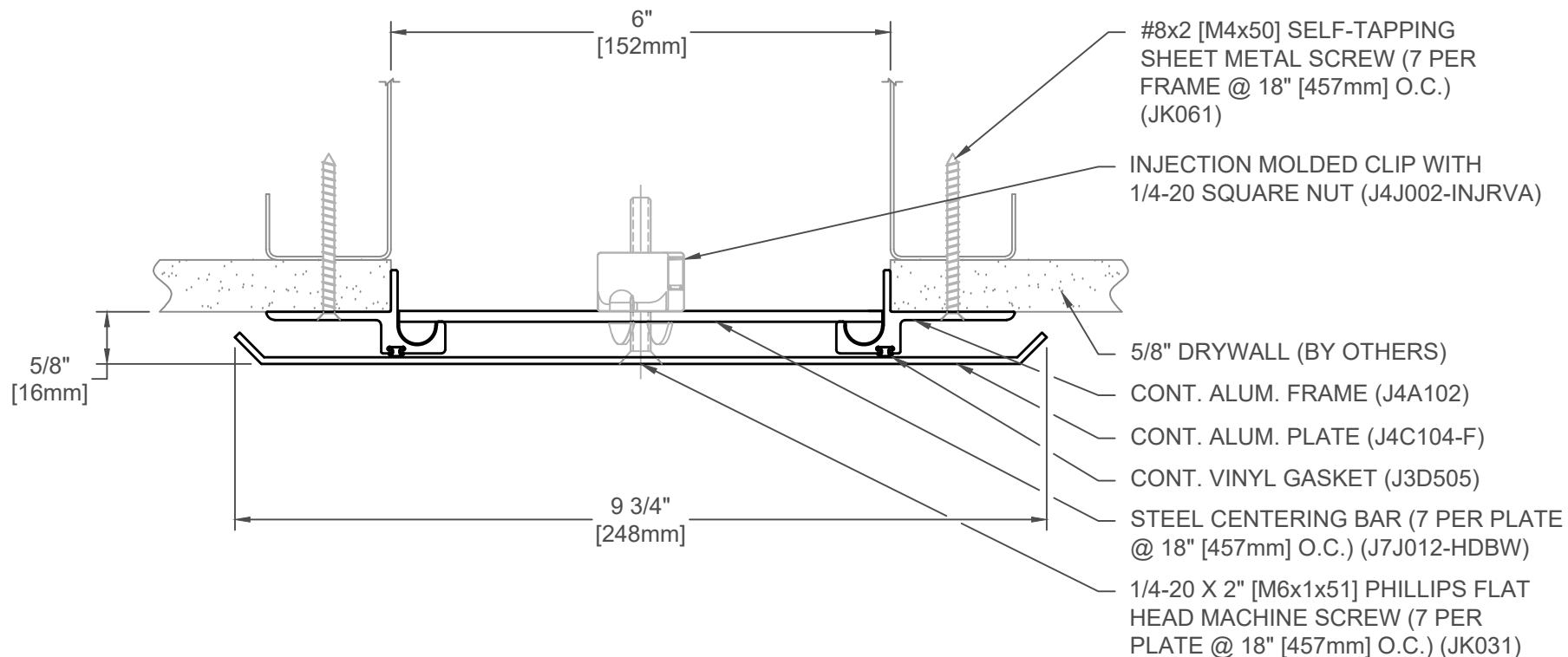

491-A07-150

JOINT WIDTH		MOVEMENT ±			
		HORIZONTAL		VERTICAL	
US	mm	US	mm	US	mm
6"	152	2-1/2"	64	3"	76

FINISH: CLEAR ANODIZED

PROJECT:

CUSTOMER:

LOCATION:

APPLICATION-
CENTERING BAR SYSTEM
SURFACE MOUNT FRAME WALL/WALL, CEILING/CEILING CONDITION

DATE: 9-7-05

SCALE: 1:2

DOC: CADJM.005/R4

inpro.

For More Information Visit: Inprocorp.com

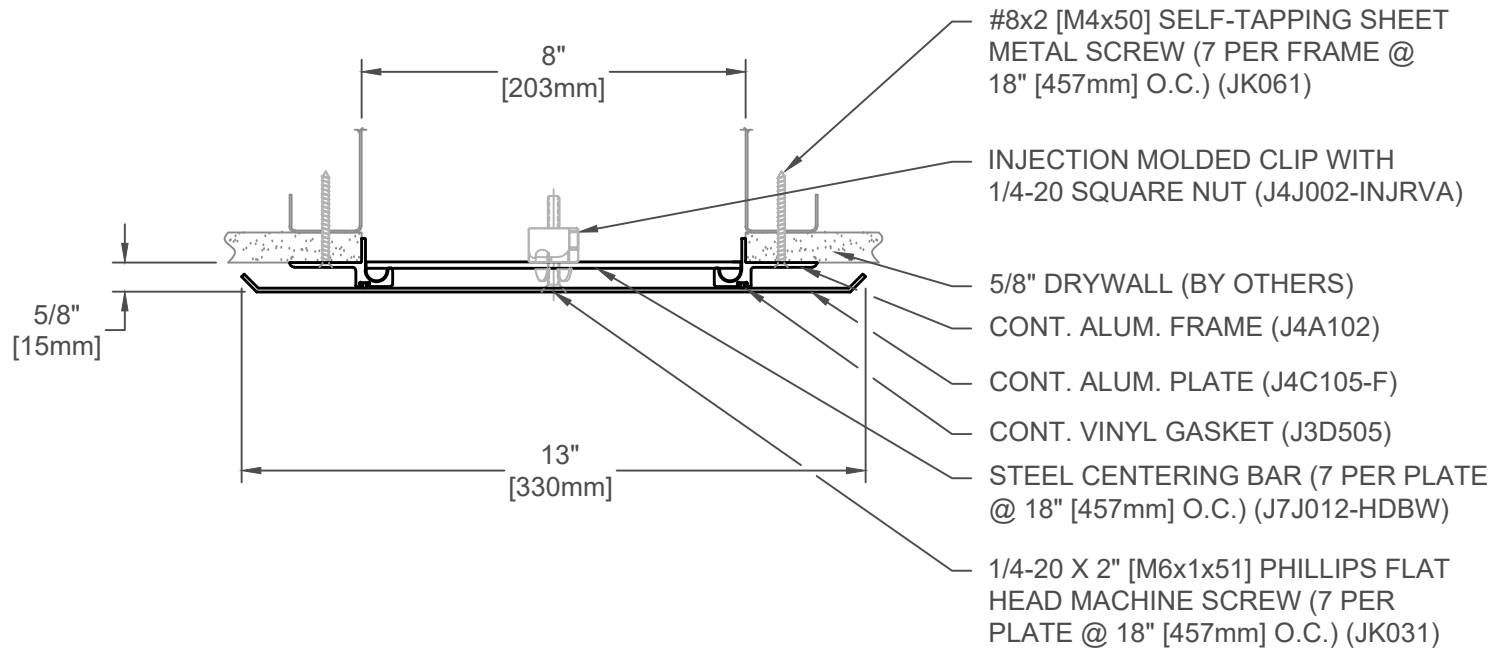

491-A07-200

JOINT WIDTH		MOVEMENT ±			
		HORIZONTAL		VERTICAL	
US	mm	US	mm	US	mm
8"	203	4"	102	4"	102

FINISH: CLEAR ANODIZED

PROJECT:

CUSTOMER:

LOCATION:

APPLICATION-
CENTERING BAR SYSTEM
SURFACE MOUNT FRAME WALL/WALL, CEILING/CEILING CONDITION

DATE: 9-7-05

SCALE: 1:4

DOC: CADJM.005/R4

inpro.

For More Information Visit: Inprocorp.com

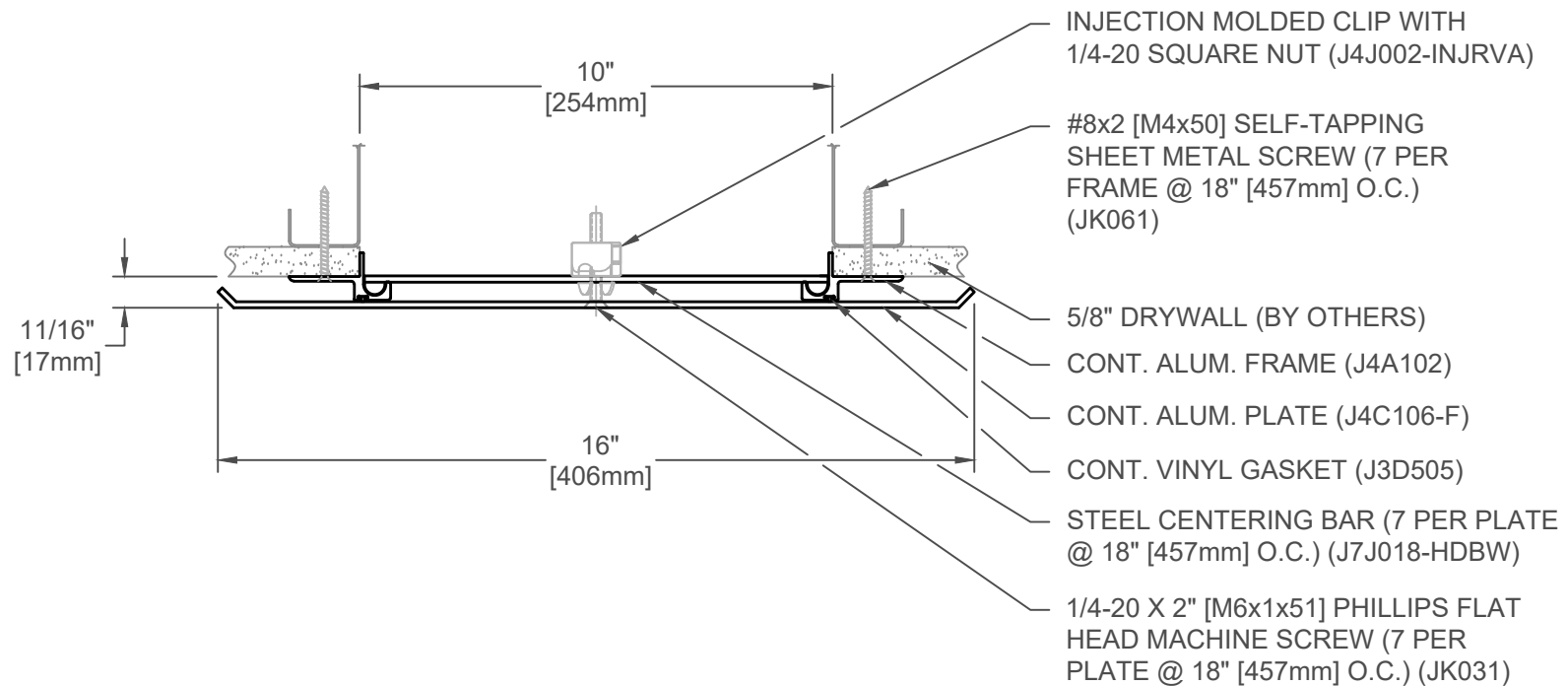

491-A07-250

JOINT WIDTH		MOVEMENT ±			
		HORIZONTAL		VERTICAL	
US	mm	US	mm	US	mm
10"	254	5"	127	5"	127

FINISH: CLEAR ANODIZED

PROJECT:

CUSTOMER:

LOCATION:

APPLICATION-
CENTERING BAR SYSTEM
SURFACE MOUNT FRAME WALL/WALL, CEILING/CEILING CONDITION

DATE: 9-7-05

SCALE: 1:4

DOC: CADJM.005/R4

inpro.

For More Information Visit: Inprocorp.com

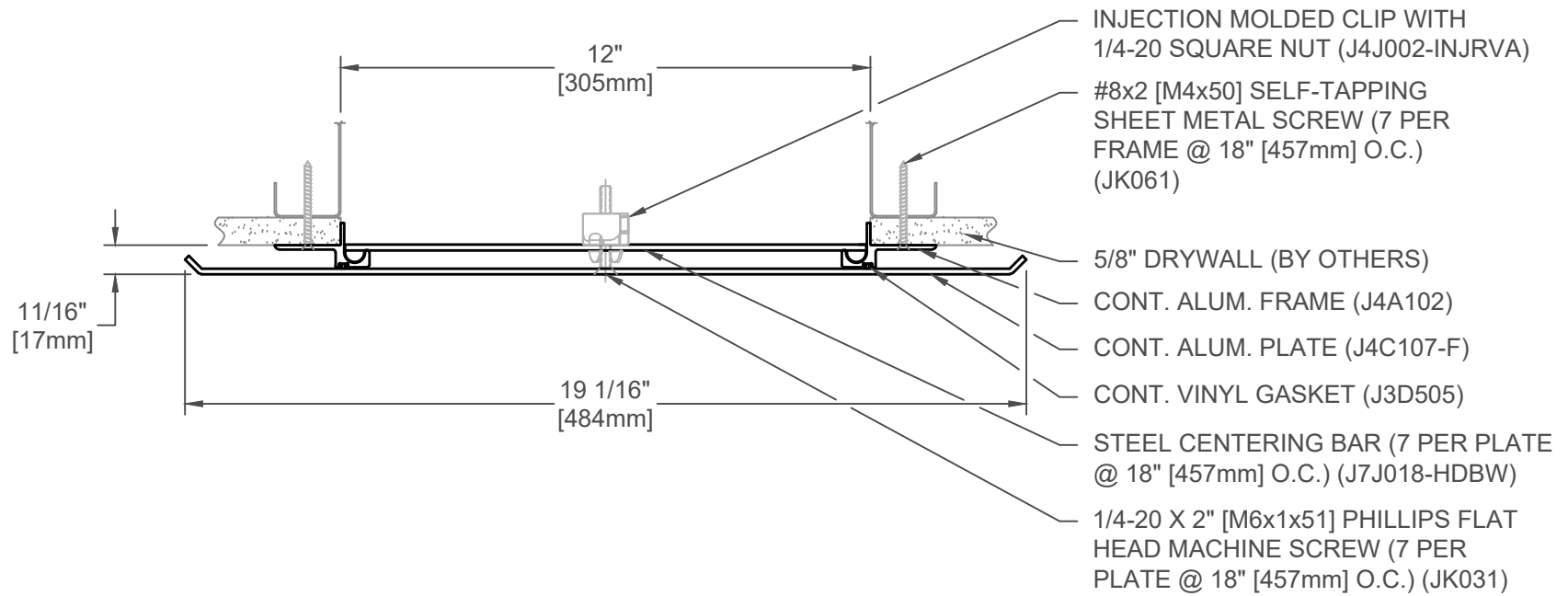

491-A07-300

JOINT WIDTH		MOVEMENT ±			
		HORIZONTAL		VERTICAL	
US	mm	US	mm	US	mm
12"	305	6"	152	6"	152

FINISH: CLEAR ANODIZED

PROJECT:

CUSTOMER:

LOCATION:

APPLICATION-
CENTERING BAR SYSTEM
SURFACE MOUNT FRAME WALL/WALL, CEILING/CEILING CONDITION

DATE: 9-7-05

SCALE: 1:4

DOC: CADJM.005/R4

inpro.

For More Information Visit: Inprocorp.com