

# Installation Instructions

Joint System: 651-A01 Roof to Roof - Wide Curb Frame

661-A01 Roof to Roof - Canted Curb Frame

691-A01 Roof to Roof - Narrow Curb Frame

**Note: Verify that the structural gap is in conformance with submittal data before beginning installation. If this is a Fire Rated Assembly, install the fire barrier before the Architectural Joint System. Refer to the fire barrier instructions for specific system installation. See Reinforced Vapor Barrier Installs (IPC.1698) for proper installation procedures. Available on inprocorp.com under Fire + Moisture Barriers.**

**Complete Assembly Overview:**

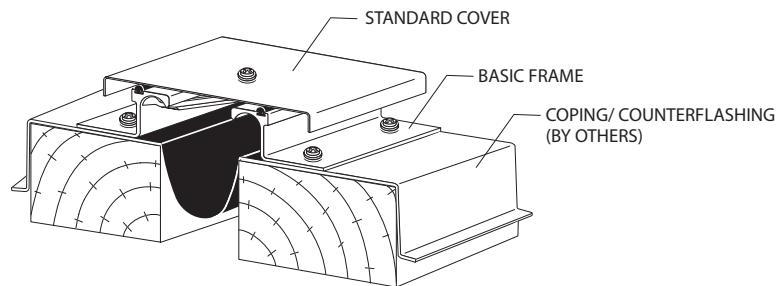

**651-A01 Wide Curb Series**

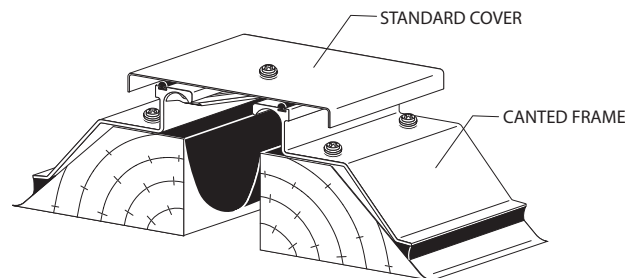

**661-A01 Canted Curb Series**

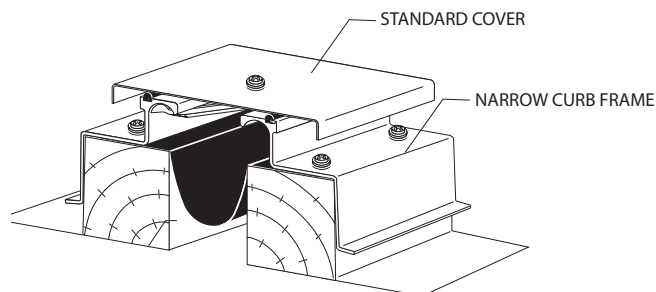

**691-A01 Narrow Curb Series**

IPC.863/REV.10

JOINTMASTER® Expansion Joint Systems

inpro.com • 800.222.5556 • 262.679.9010

World Headquarters S80 W18766 Apollo Drive, Muskego, WI 53150 USA

Installation Hotline: 866.394.6776

**inpro**®

# Installation Instructions

Joint System: 651-A01 Roof to Roof - Wide Curb Frame

661-A01 Roof to Roof - Canted Curb Frame

691-A01 Roof to Roof - Narrow Curb Frame

## Roof Curb Conditions:

Install required curbs level with each other across the joint. Reference curb and proper flashing details below for each system.

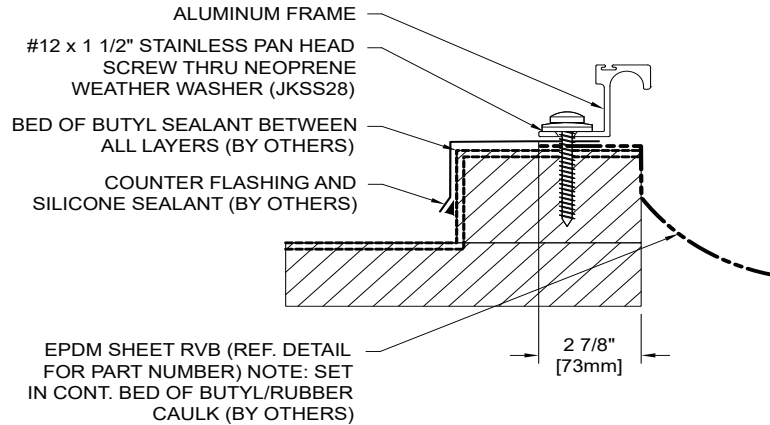

### 651-A01 Wide Curb Series

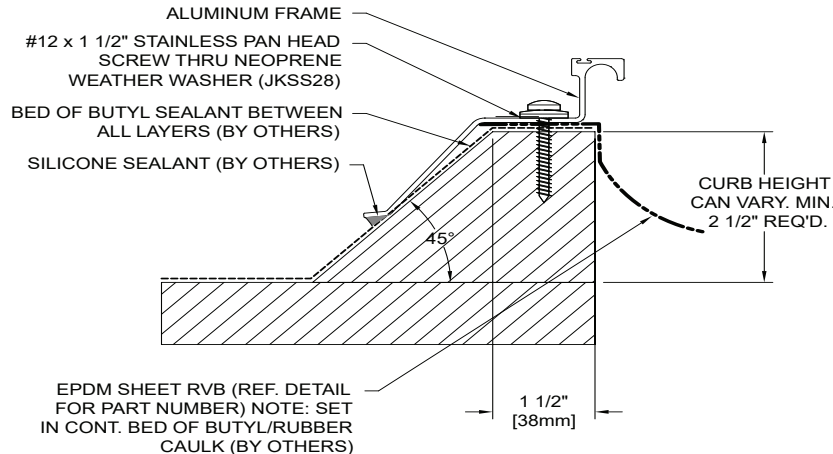

### 661-A01 Canted Curb Series

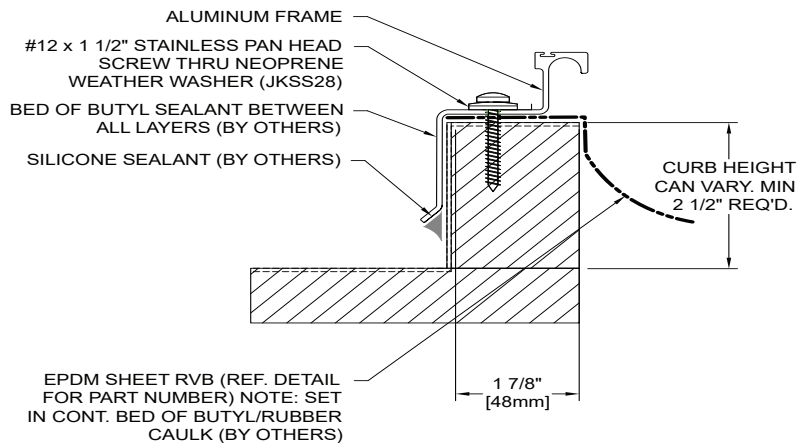

### 691-A01 Narrow Curb Series

JOINTMASTER® Expansion Joint Systems

inpro.com • 800.222.5556 • 262.679.9010

World Headquarters S80 W18766 Apollo Drive, Muskego, WI 53150 USA

Installation Hotline: 866.394.6776

**inpro**®

# Installation Instructions

Joint System: 651-A01 Roof to Roof - Wide Curb Frame

661-A01 Roof to Roof - Canted Curb Frame

691-A01 Roof to Roof - Narrow Curb Frame

**Figure 1**

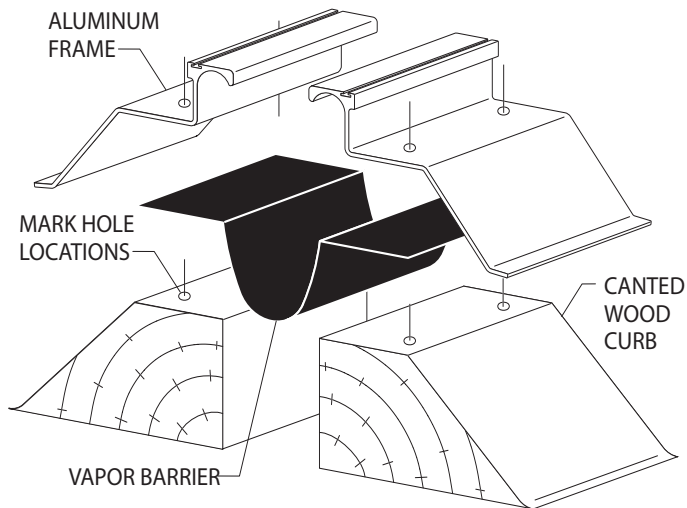

**Figure 2**

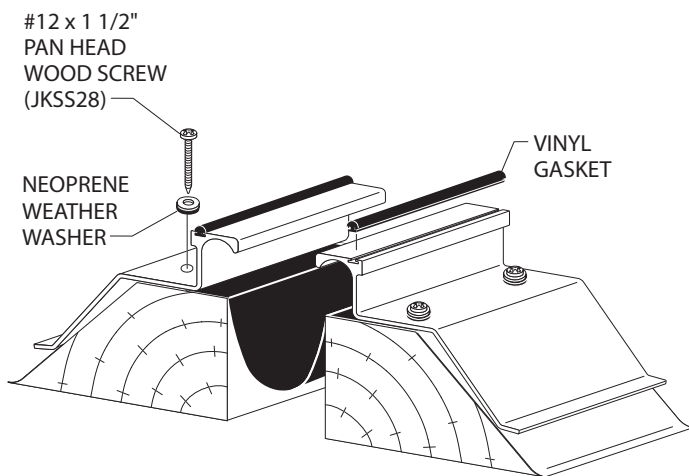

1. Install moisture barrier membrane into joint. Reference complete "Vapor Barrier" instructions online at [inprocorp.com](http://inprocorp.com).

**Figure 1 Installing Frames (661 Series depicted)**

2. Cut the aluminum components to the desired length.
3. Place the frames firmly against the wood curb with the radius profile of the frames facing the structural gap.
4. Reference project details to verify final frame position.
5. Mark the pre-drilled hole locations on the curb and remove the frames.
6. Drill all marked holes on the curb using a 1/8" (3mm) drill bit to 1 1/2" (25mm) depth.
7. Lay continuous bed of butyl or polyurethane caulk (contractor furnished) on top of both curbs over vapor barrier membrane.

**Figure 2 Installing Frames**

8. Return the frames into position over the drilled hole locations. Secure in place with one JKSS28 #12 x 1 1/2" pan head wood screw through a JK080 neoprene weather washer.
9. Slide the vinyl gasket into the top of the frame's.

# Installation Instructions

Joint System: 651-A01 Roof to Roof - Wide Curb Frame

661-A01 Roof to Roof - Canted Curb Frame

691-A01 Roof to Roof - Narrow Curb Frame

Figure 3

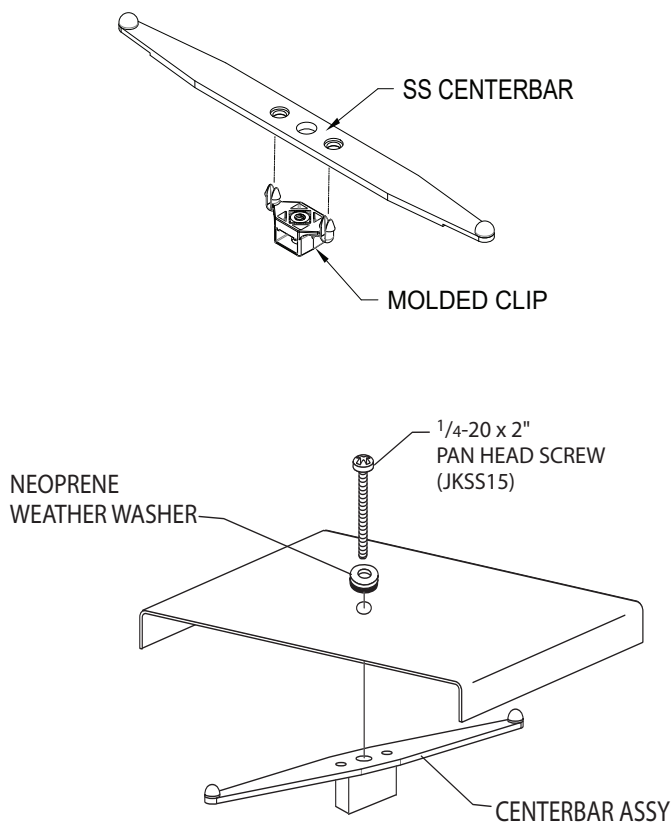

Figure 3 Assembling Cover and Centerbar

9. Assemble the molded clip with the ball ends facing up.
10. Assemble the plate by inserting one JKSS15 1/4-20x2" pan head screw through a neoprene weather washer for each counter-sunk hole in the aluminum plate. Loosely thread one centering bar on each screw with the rounded domes facing the plate. Centering bars should be aligned diagonally and parallel to each other.
11. Place the plate assembly centered over the frames. Tighten the screws to engage the centerbar in the frame channels.
12. See page 1 for complete assemblies.
13. Clean exposed surface with non-solvent cleaner, such as 409, as required

Figure 4

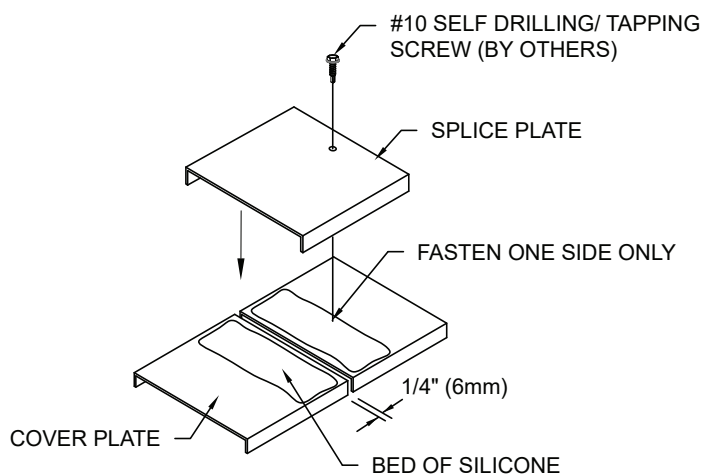

Figure 4 Splice Plate Installation Instructions

14. Leave a min. of 1/4" (6mm) gap between the full sections
15. Apply a bed of continuous silicone sealant (contractor furnished) to splice plate over seam to ensure a water tight seal.
16. Fasten a min. of one #10 (5mm) self drilling/ tapping screw, 1" (25mm) (contractor furnished) in from the center top of the splice plate on one side. Do not fasten both ends of the splice plate