

# Installation Instructions

Joint System: 651-A02 Roof to Wall - Wide Curb Frame

661-A02 Roof to Wall - Canted Curb Frame

691-A02 Roof to Wall - Narrow Curb Frame

**Note: Verify that the structural gap is in conformance with submittal data before beginning installation. If this is a Fire Rated Assembly, install the fire barrier before the Architectural Joint System. Refer to the fire barrier instructions for specific system installation. See Reinforced Vapor Barrier Installs (IPC.1698) for proper installation procedures. Available on inprocorp.com under Fire + Moisture Barriers.**

## Complete Assembly Overview:

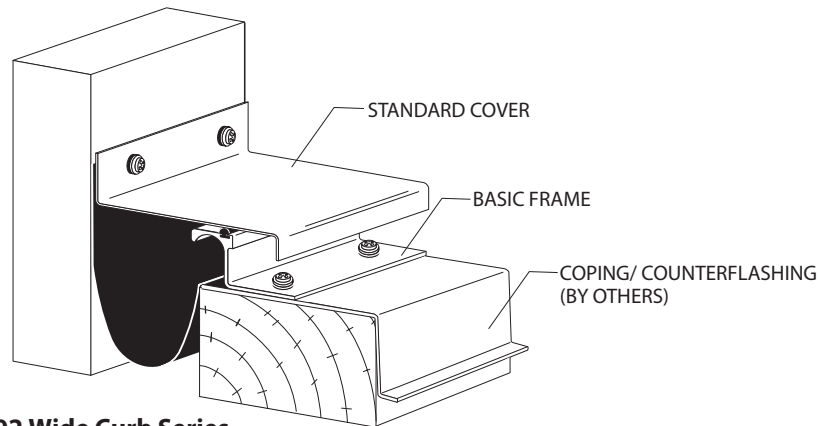

**651-A02 Wide Curb Series**

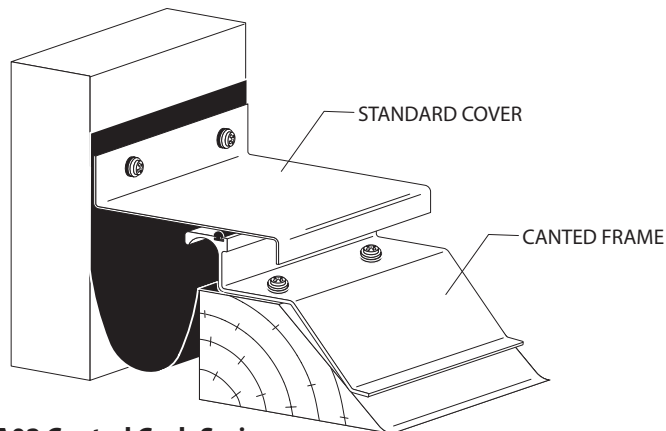

**661-A02 Canted Curb Series**

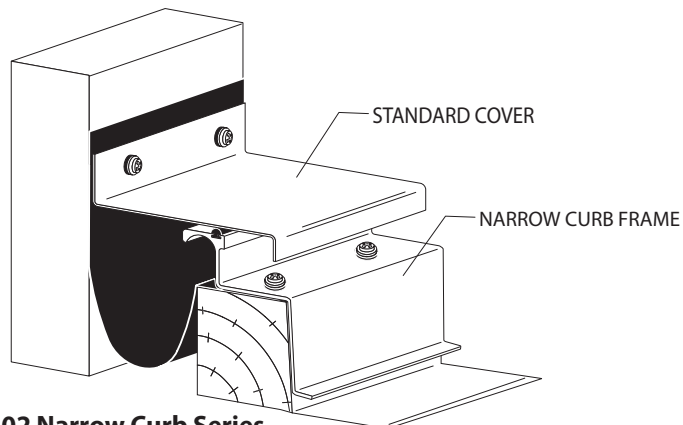

**691-A02 Narrow Curb Series**

IPC.862/REV.9

JOINTMASTER® Expansion Joint Systems

inpro.com • 800.222.5556 • 262.679.9010

World Headquarters S80 W18766 Apollo Drive, Muskego, WI 53150 USA

Installation Hotline: 866.394.6776

**inpro**®

# Installation Instructions

Joint System: 651-A02 Roof to Wall - Wide Curb Frame

661-A02 Roof to Wall - Canted Curb Frame

691-A02 Roof to Wall - Narrow Curb Frame

## Roof Curb Conditions:

Install required curbs level with each other across the joint. Reference curb and proper flashing details below for each system.

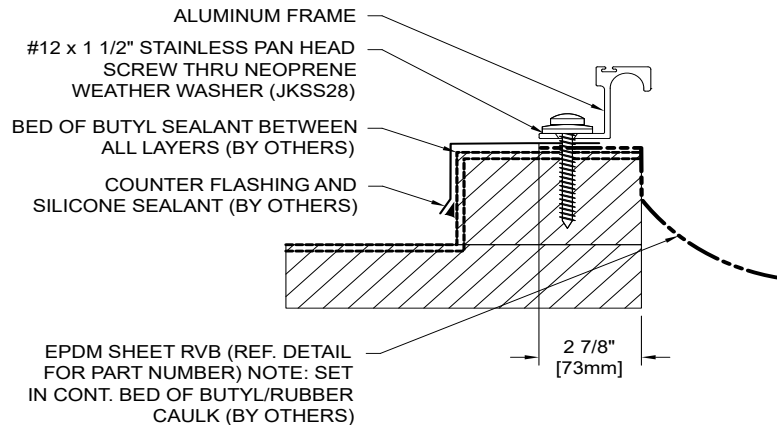

### 651-A02 Wide Curb Series

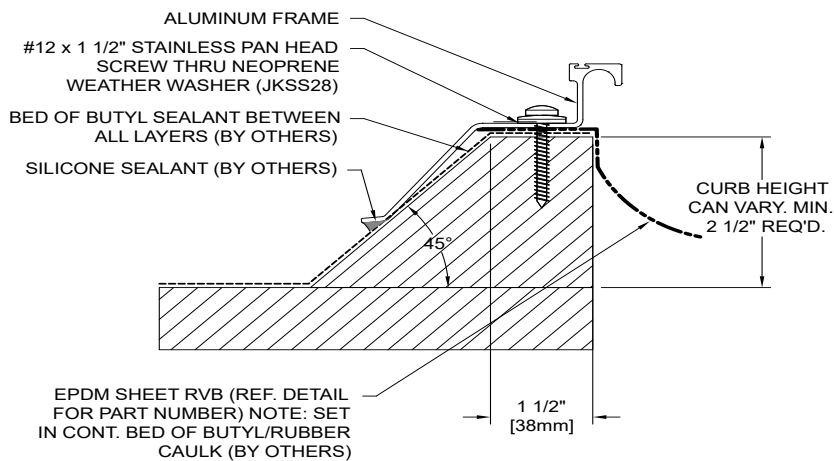

### 661-A02 Canted Curb Series

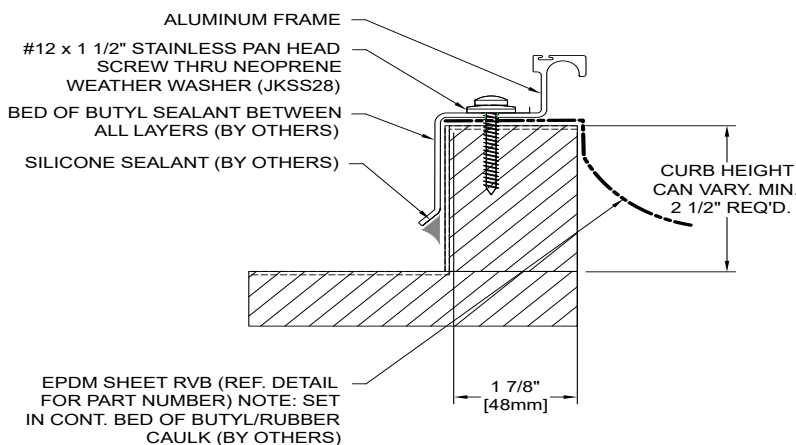

### 691-A02 Narrow Curb Series

JOINTMASTER® Expansion Joint Systems

inpro.com • 800.222.5556 • 262.679.9010

World Headquarters S80 W18766 Apollo Drive, Muskego, WI 53150 USA

Installation Hotline: 866.394.6776

**inpro**®

# Installation Instructions

Joint System: 651-A02 Roof to Wall - Wide Curb Frame

661-A02 Roof to Wall - Canted Curb Frame

691-A02 Roof to Wall - Narrow Curb Frame

**Figure 1**

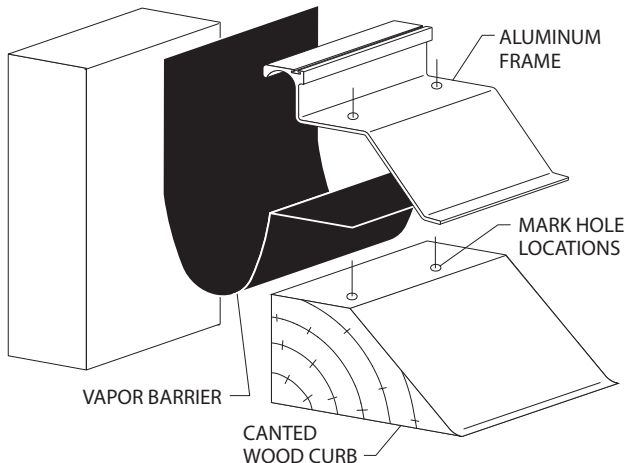

**Figure 2**

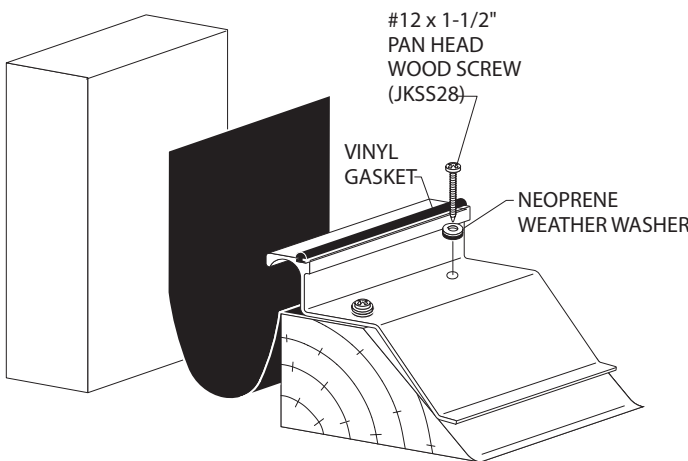

**Figure 3**

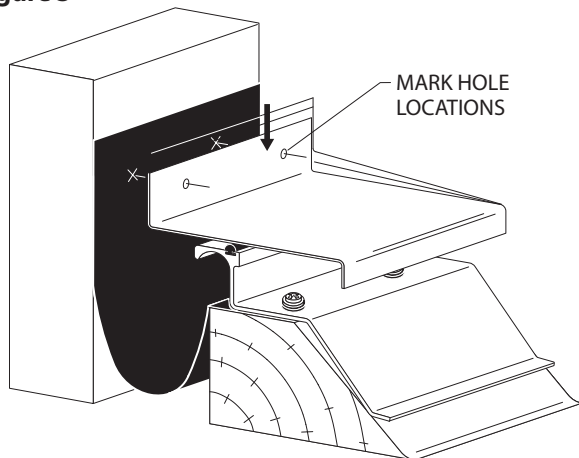

1. Install moisture barrier membrane into joint. Reference complete "Vapor Barrier" instructions online at [inprocorp.com](http://inprocorp.com).

### Figure 1 Installing Frames (661 Series depicted)

2. Cut the aluminum components to the desired length.
3. Place the frames firmly against the wood curb with the radius profile of the frames facing the structural gap.
4. Reference project details to verify final frame position.
5. Mark the pre-drilled hole locations on the curb and remove the frames.
6. Drill all marked holes on the curb using a 1/8" (3mm) drill bit to 1 1/2" (25mm) depth.
7. Lay continuous bed of butyl or polyurethane caulk (contractor furnished) on top of both curbs over vapor barrier membrane.

### Figure 2 Installing Frames

8. Return the frames into position over the drilled hole locations. Secure in place with one JKSS28 #12 x 1 1/2" pan head wood screw through a JK080 neoprene weather washer.
9. Slide the vinyl gasket into the top of the frame's.

### Figure 3 Installing Cover

10. Place the half plate over the structural gap with the 2" [52 mm] straight leg (pre-drilled hole side) firmly against the wall. Rest the horizontal base leg of the half plate firmly on the frame's vinyl gasket. Align parallel to the wall
11. Mark hole locations on substrate using pre-drilled holes in the half plate. Remove the plate from the joint gap.
12. Drill all marked hole locations on the wall using a 1/8" [3mm] drill bit to 1 1/2" [38mm] depth.

# Installation Instructions

Joint System: 651-A02 Roof to Wall - Wide Curb Frame

661-A02 Roof to Wall - Canted Curb Frame

691-A02 Roof to Wall - Narrow Curb Frame

**Figure 4**

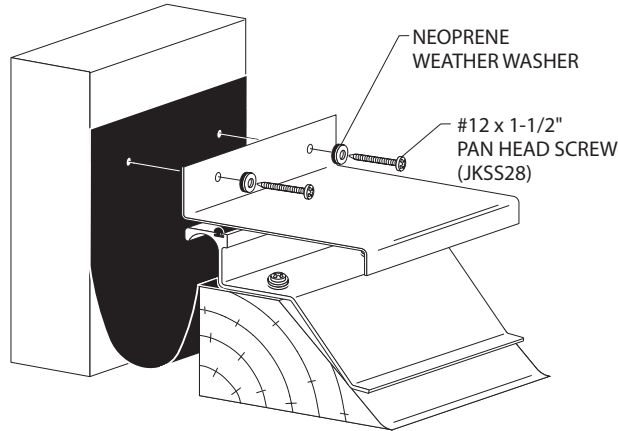

**Figure 4 Installing Cover**

13. Return aluminum half plate over structural gap. Resting the horizontal base leg of the half plate firmly on the frame's vinyl gasket. Fasten aluminum half plate to wall surface using supplied fasteners.

**Figure 5 Assembling Centerbar**

(For joint widths larger than 6" (152mm))

14. Assemble the molded clip with the ball end facing up.
15. Thread JK112 1/4-20 hex head screw into the centerbar riv-nut leaving 7/16" [11mm] height from top of center bar as shown.

**Figure 5**

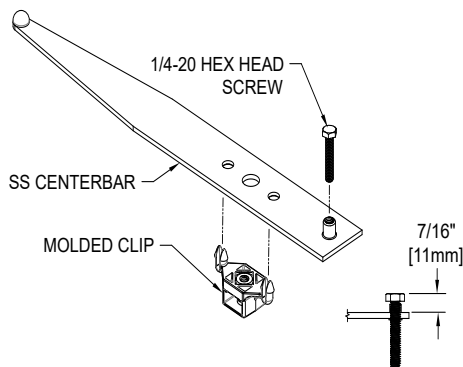

**Figure 6 Assembling Cover and Centerbar**

16. Assemble the plate by inserting one JKSS15 1/4-20x2" pan head screw through a neoprene weather washer for each counter-sunk hole in the aluminum plate. Loosely thread one centering bar on each screw with the rounded domes facing the plate. Centering bars should be aligned diagonally and parallel to each other.

**Figure 6**

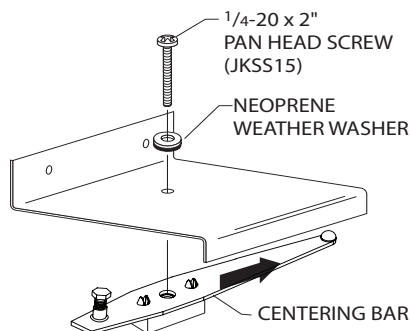

# Installation Instructions

Joint System: 651-A02 Roof to Wall - Wide Curb Frame

661-A02 Roof to Wall - Canted Curb Frame

691-A02 Roof to Wall - Narrow Curb Frame

Figure 7

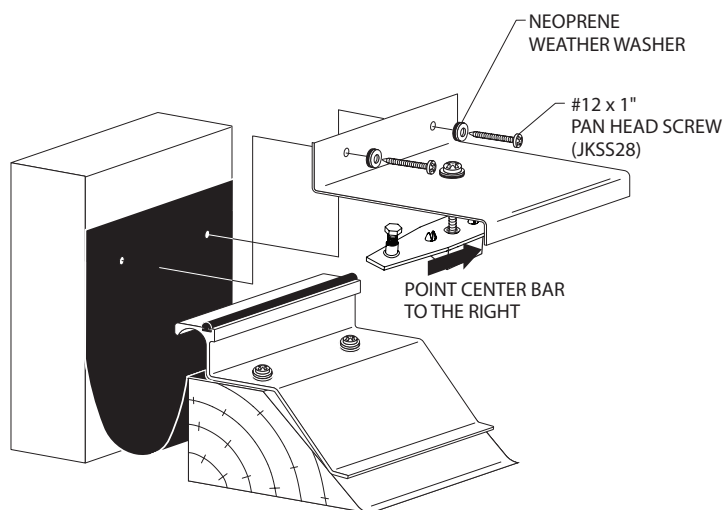

Figure 7 Assembling Cover

17. Place the plate assembly centered over the frames. Tighten the screws to engage the centerbar in the frame channel.
18. See page 1 for complete assemblies.
19. Clean exposed surface with non-solvent cleaner, such as 409, as required

Figure 8

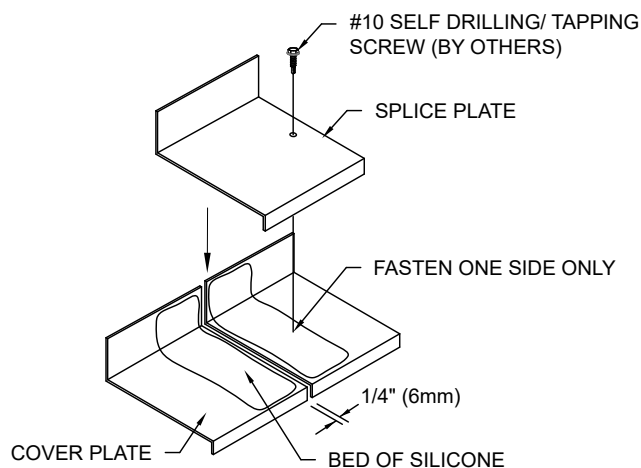

Figure 8 Splice Plate Installation Instructions

20. Leave a min. of 1/4" (6mm) gap between the full sections
21. Apply a bed of continuous silicone sealant (contractor furnished) to splice plate over seam to ensure a water tight seal.
22. Fasten a min. of one #10 (5mm) self drilling/ tapping screw, 1" (25mm) (contractor furnished) in from the center top of the splice plate on one side. Do not fasten both ends of the splice plate