

Installation Instructions

Joint System: 787-A02

Note: Verify that the structural gap is in conformance with submittal data before beginning installation. If this is a Fire Rated Assembly, install the fire barrier before the Architectural Joint System. Refer to the fire barrier instructions for specific system installation.

For installations subject to non-conditioned applications, a thermal gap is required between the end-to-end connections of the frames and covers. When installing in warm conditions (ie- 75F / 22C or greater), the covers can abut each other directly, however during cooler weather installs (70F / 21C or less), the recommended gap width between frames and covers is 1/8" (3mm) min. Prior to installing the next frame in sequence, apply polyurethane sealant (By Others) to the end of the frame / cover before seating the next profile.

FIG. 1

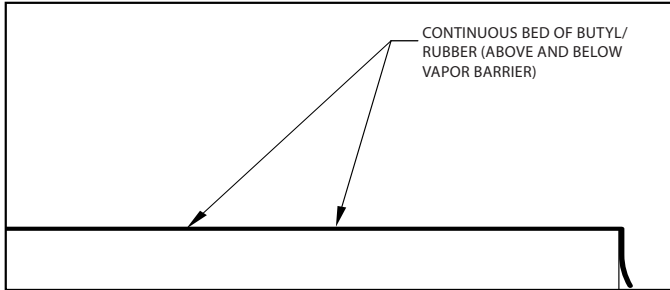

FIG. 1a

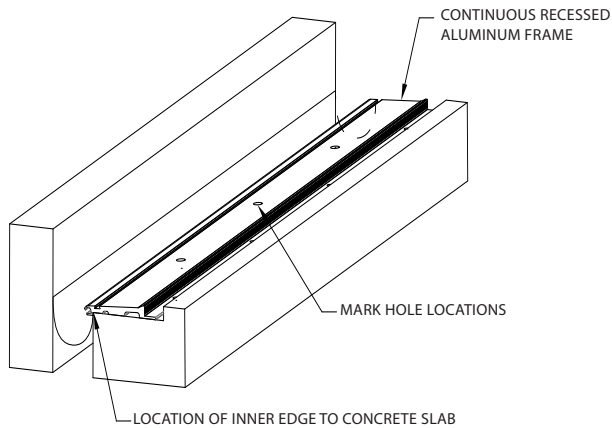
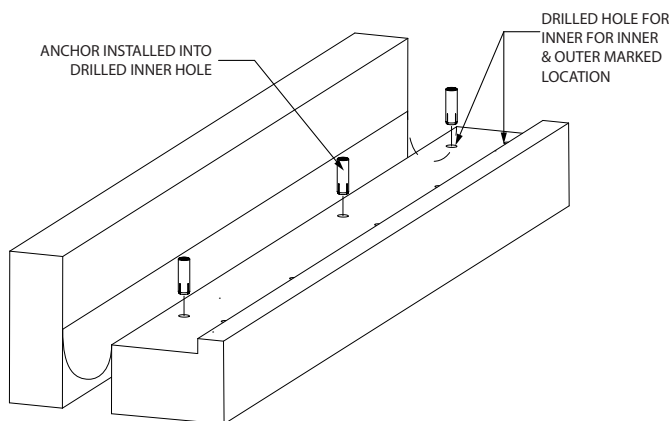

FIG. 1b



1. Install the architectural joint system on a level surface within the blockout. The top of the aluminum frame should coincide with the finish floor. This may require adding leveling compound to raise the tops of the frames.

Figure 1

3. Clean the top of the blockout thoroughly, then apply a bed of butyl or polyurethane sealant. Reference official Reinforced Vapor Barrier (RVB) instructions online to properly address pitch, seams and changes in direction. Set the EPDM and ensure membrane is set to the back of the blockout on both sides allowing it to drape down into the gap (Fig. 1).

2. Place the recessed aluminum frames with the inner edge of the recessed frames location as shown.

4. Note there are two sets of holes- countersunk holes in the middle of the frame closer to the joint, and straight holes in the outer profile. Each set of holes require different drill depths. Using the frame as a template, use a 3/8" [9.5mm] concrete bit (not included), drill to a depth of 1 1/2" [40mm] for the inner holes (*pilot holes), and 2 3/4" [70mm] for the outer set (*final holes) from the top of the frame. (Fig. 1)

5. Remove the recessed frames from the blockout.

6. Using a 1/2" [12mm] concrete bit (not included) drill out the inner set of holes (closest to joint) to a depth of 1 5/8" [42mm]. Vacuum and blow out the holes to remove all debris and dust.

7. Place the drop-in anchors (JK214) and seat to bottom of hole. Insert the supplied setting punch (JKSS24-2) and hammer down sharply 4-5 times to set the internal plug securely. Return frames to original position.

8. Secure frames in place using the 3/8" [9.5mm] hex head concrete screw anchors (JK173) for the outer holes within the blockout.

9. Next, install the 3/8" stainless steel flathead screws (JK214) into the anchors for the middle portion.

IPC.1563/REV.7

JOINTMASTER® Expansion Joint Systems

inpro.com • 800.222.5556 • 262.679.9010

World Headquarters S80 W18766 Apollo Drive, Muskego, WI 53150 USA

Installation Hotline: 866.394.6776

inpro®

Installation Instructions

Joint System: 787-A02

FIG. 2

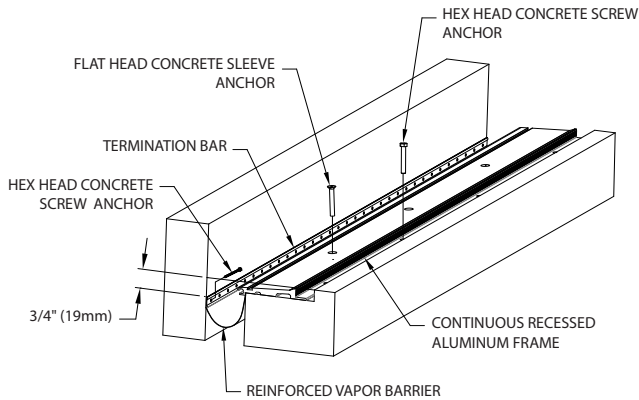

FIG. 3

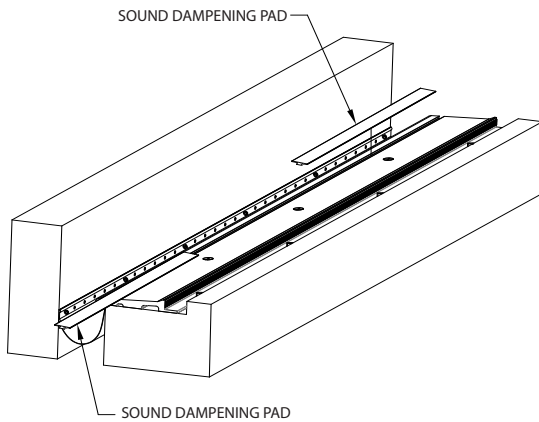

FIG. 4

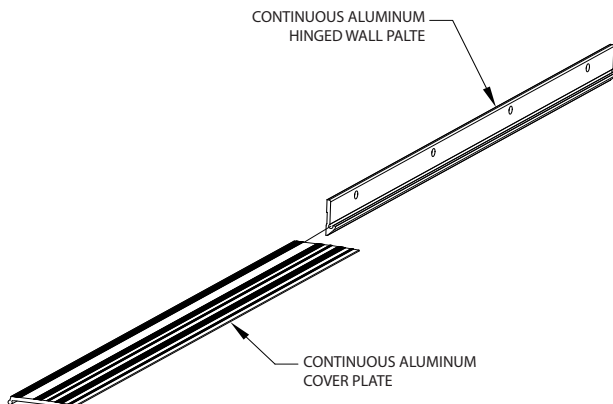

Figure 2

10. Hold the termination bar 3/4" [19mm] down from the finish floor height and drill a 3/16" [5mm] hole 2 1/2" (64mm) deep 12" (305mm) on center.

11. Use a JK001 3/16" x 2 1/4" hex head concrete screw to fasten the termination bar to the concrete wall.

12. Trim the excess vapor barrier to the top of the termination bar.

Figure 3

13. Slide or press the sound dampening seal in the dovetail groove. 10" (254mm) & 12" (304mm) 787 systems have 2 dovetail grooves for seals.

Figure 4

14. Slide the aluminum cover plate into the the aluminum hinged wall frame.

Figure 5

15. Locate continuous aluminum hinged wall frame top 1 7/8 (48mm) from the finished floor. Be sure the bottom of the aluminum cover plate is parallel with the top of the mounted aluminum recessed frame.

16. Mark the holes on the concrete wall and remove the cover plate assembly.

17. Drill all marked holes on the substrates using a 1/2" [12mm] concrete drill bit. Holes should be drilled 2" [52mm] deep. **Seat anchor per step 7.**

18. Return the cover plate assembly in position over the drilled hole locations and secure in place with one JK214 3/8" [9.5mm] flat head screw for each hole.

19. Put a bead of silicone between the aluminum hinged wall frame and cover plate.

***SEE EXAMPLE FIG.5**

Installation Instructions

Joint System: 787-A02

FIG. 5

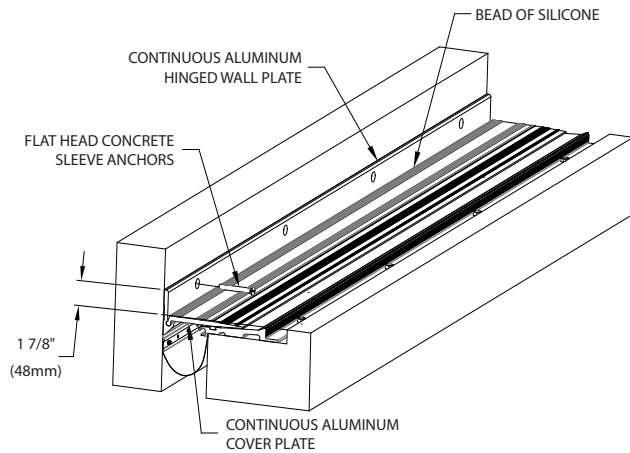

FIG. 6

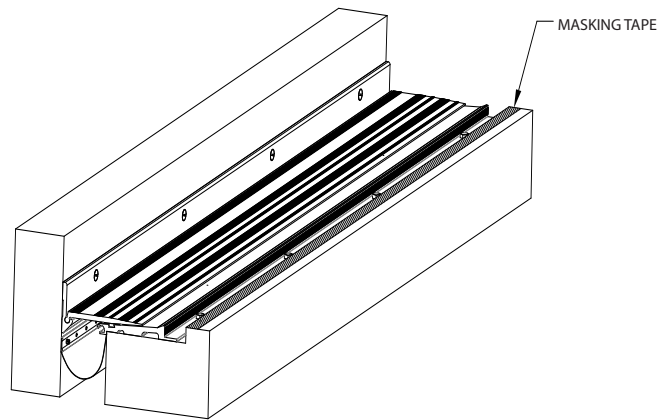

Figure 6

20. Use masking tape on the concrete slab next to the blockout.
21. Backfill the blockout with elastomeric concrete level with the adjacent concrete slab.
22. Remove masking tape from the concrete slab.
23. Clean the exposed surfaces with a non-solvent cleaner, such as 409, as required.

Figure 7 (787-A02 Completed installation)

