

Wall + Ceiling Expansion Joint Systems



Architectural Products



They're not just Expansion Joint Systems.

They're masters of movement.

Acoustic authorities. Waterproofing warriors. Forbidders of Fire. Air and moisture mercenaries. They're on a mission to maintain the integrity of buildings in the face of earthquakes, hurricanes, fires and just plain everyday forces. Often the unsung heroes of building protection, they're built to do what they do every day because that's what it takes to keep people safe.

04

Why Inpro®
04 Why Inpro®

06

Wall + Ceiling Systems
06 Model Number Guide
08 Selection Guide
10 100 Series
13 115 Series
14 200 Series
18 300 Series
21 400 Series
22 800 Series

26

Recent Projects
26 Recent Projects



ChristChurch, Justice + Emergency Services Precinct | Christchurch, New Zealand
353 Wall + Ceiling System

why inpro®

Our Expansion Joint + Fire Barrier Systems are engineered to handle the unique conditions of your building.

engineered obsessively

We constantly test and review our systems for continuous innovation to provide you with the best solutions. Yeah we're obsessed, but in a good way.

protected by design

From ensuring smooth transitions for rolling equipment carts, gurneys and wheelchairs, to preventing the spread of smoke and fire, we integrate building protection right into the product's design.

manufactured with care

As the manufacturer, we verify that only the best products are shipped out to your project.

Model Number Guide

Understanding product numbers

We've made it even easier for you to place the right system configuration in your next project. Just visit inpro.com to download our industry leading specifications which are adaptable and easy to work with...just like us!

Series | Model

100	Elastomeric Seal Systems for Floors/Walls/Ceilings
200	Dual Elastomeric Seal Systems for Floors/Walls/Ceilings
300	Glide Plate Seismic Systems for Floors/Walls/Ceilings
400	Center Bar Seismic Systems for Floors/Walls/Ceilings
500	Seismic Systems for Floors
600	Exterior Seismic Systems for Walls and Roofs
700	Heavy Duty Seismic Systems for Floors
800	Cover Plate Systems for Floors / Walls / Ceilings
900	Fire Barrier Systems
1000	Exterior Compression Seals
1100	Foam Seals
1200	Silicone Foam Seals

Condition

A01	Floor to Floor/Roof to Roof
A02	Floor to Wall/Roof to Wall
A07	Wall to Wall or Ceiling to Ceiling
A09	Wall to Corner or Ceiling to Wall
V18	Ceiling to Wall for Acoustical Ceiling Systems
V24	Ceiling to Ceiling for Acoustical Ceiling Systems

Joint Width

025	1" (25mm)
038	1½" (38mm)
050	2" (51mm)
075	3" (76mm)
100	4" (102mm)
125	5" (125mm)
150	6" (152mm)
200	8" (203mm)
300	12" (305mm)
350	14" (356mm)
400	16" (406mm)
450	18" (457mm)
500	20" (508mm)
600	24" (600mm)

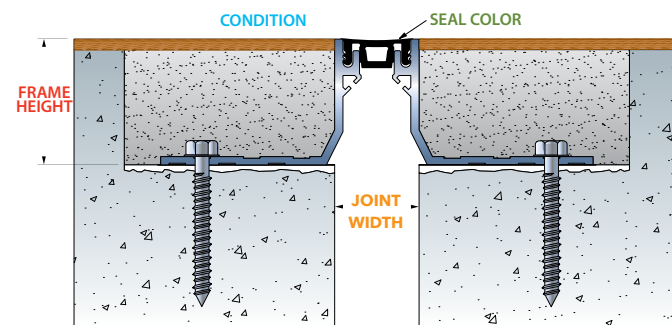
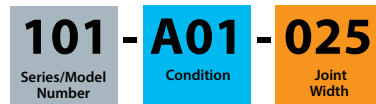

Loading Definitions

Standard/Moderate/Heavy Duty are designations as they relate to load ratings. These are provided as a guideline to assist in making a preliminary product selection for a given application.

- "Standard" suggests use in common applications such as typical office settings or other spaces where pedestrian traffic or occasional rubber-wheeled traffic like mail carts and light-weight cleaning equipment, luggage, etc. is the norm.
- "Moderate" suggests applications where occasional heavier maintenance equipment with soft rubber tires (such as gurneys, light duty scissor lifts, motorized cleaning equipment, etc.) would be added to the standard traffic. The systems in this category are comprised of heavier aluminum extrusions, with thicker walled extruded rubber inserts.
- "Heavy Duty" is for applications where truly heavy loads (such as vehicles) or high-point loads (such as mobile medical equipment, coin carts, materials handling equipment, etc.) are the norm. They are capable of multi-directional movements and are also available in surface or blockout mounted variations.



Forest Park Middle School | Franklin, WI
114 ceiling system, 432 floor system, 300 wall system

Wall + Ceiling Systems

ChristChurch, Justice + Emergency Services Precinct | Christchurch, New Zealand
353 Wall + Ceiling System

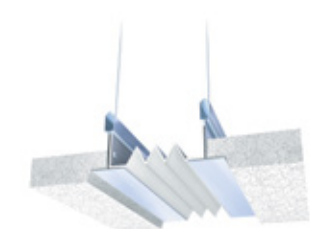
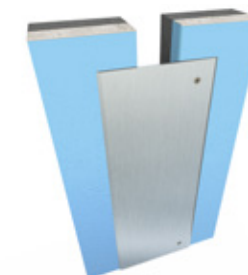
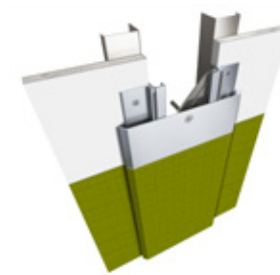

	Single Seal	Dual Seal	Glide Plate	General Purpose	Surface Mounted Cover Plate	Acoustical Ceiling
Page Number	10	14	18	21	22	13
Series	100, 600	200	300	400	100, 800	100, 800
Models	101, 112, 113, 114, 118, 611, 612	221, 233	300, 318, 353/355	481, 491	104, 801, 804, 808, 811	115, 821
Joint Opening	1"-24" (25mm - 600mm)	2"-36" (50mm - 900mm)	1"-12" (25mm - 300mm)	2"-24" (50mm - 600mm)	1"-6" (25mm - 150mm)	1"-6" (25mm - 150mm)
Movement +/-	25%-50% of Joint Width	25%-50% of Joint Width	50% of Joint Width	50% of Joint Width	50% of Joint Width	50% of Joint Width

Single Seal Systems

% of Movement ±25-50% | Joint Width 1" (25mm) - 6" (150mm)

Surface mount designs are ideal for renovations. 100 Series systems allow for Standard loading conditions such as offices, restaurants, cafeterias and clean rooms.



- Dual durometer Santoprene™ seal provides secure fit and optimal flexibility.
- Frames adaptable to multiple floor finishes including concrete, VCT, sheet vinyl and carpet.
- Snap-fit design for easy on-site assembly.
- Optional moisture barrier available.
- Mill finish standard.
- Integrates with the following floor systems: 101-A01/A02, 104-A01/A02, 112-A01/A02, 113-A01/A02, 118-A01/A02.
- Standard and custom seal colors available.

112 Series



- Snap-in frame accepts 5/8" (16mm) drywall. No finish required, saving on site installation costs.
- Clear anodized aluminum for a decorative finish.
- Finish options available.

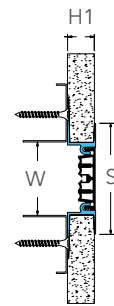

A07 Wall/Wall Ceiling/Ceiling (2" (51mm) system shown)

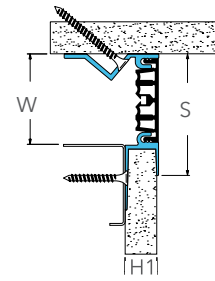

A09 Wall/Corner Wall/Ceiling (3" (75mm) system shown)

Application	System	W		H1		H2		S		B		Movement +/-			
		Joint Width		Frame Height 1		Height 2		Sightline		Blockout		Horizontal		Vertical	
		US	mm	US	mm	US	mm	US	mm	US	mm	US	mm	US	mm
Wall to Wall Ceiling to Ceiling	112-A07-025	1"	25	5/8"	16	*	*	2"	51	*	*	1/4"	6	1/4"	6
	112-A07-038	1 1/2"	38	5/8"	16	*	*	2 7/16"	62	*	*	3/8"	10	3/8"	10
	112-A07-050	2"	51	5/8"	16	*	*	2 7/8"	73	*	*	1/2"	13	1/2"	13
	112-A07-075	3"	76	5/8"	16	*	*	4"	102	*	*	3/4"	19	3/4"	19
Wall to Corner Wall to Ceiling	112-A09-025	1"	25	5/8"	16	*	*	1 1/2"	38	*	*	1/4"	6	1/4"	6
	112-A09-038	1 1/2"	38	5/8"	16	*	*	1 15/16"	49	*	*	3/8"	10	3/8"	10
	112-A09-050	2"	51	5/8"	16	*	*	2 3/8"	60	*	*	1/2"	13	1/2"	13
	112-A09-075	3"	76	5/8"	16	*	*	3 3/8"	86	*	*	3/4"	19	3/4"	19

113 Series



- Frame allows for finish with joint compound or wall covering.
- Dual durometer seal provides secure fit and optimal flexibility.
- Sightline reduced to width of flexible seals.

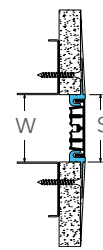

A07 Wall/Wall Ceiling/Ceiling (2" (51mm) system shown)

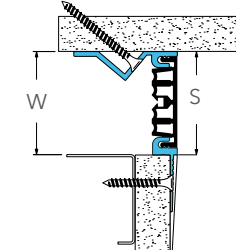

A09 Wall/Corner Wall/Ceiling (3" (75mm) system shown)

Application	System	W		H1		H2		S		B		Movement +/-			
		Joint Width		Frame Height 1		Height 2		Sightline		Blockout		Horizontal		Vertical	
		US	mm	US	mm	US	mm	US	mm	US	mm	US	mm	US	mm
Wall to Wall Ceiling to Ceiling	113-A07-025	1"	25	*	*	*	*	1"	25	*	*	1/4"	6	1/4"	6
	113-A07-038	1 1/2"	38	*	*	*	*	1 1/2"	36	*	*	3/8"	10	3/8"	10
	113-A07-050	2"	51	*	*	*	*	2"	47	*	*	1/2"	13	1/2"	13
	113-A07-075	3"	76	*	*	*	*	3"	76	*	*	3/4"	19	3/4"	19
Wall to Corner Wall to Ceiling	113-A09-025	1"	25	*	*	*	*	1"	25	*	*	1/4"	6	1/4"	6
	113-A09-038	1 1/2"	38	*	*	*	*	1 1/2"	36	*	*	3/8"	10	3/8"	10
	113-A09-050	2"	51	*	*	*	*	2"	47	*	*	1/2"	13	1/2"	13
	113-A09-075	3"	76	*	*	*	*	3"	73	*	*	3/4"	19	3/4"	19

101 Series

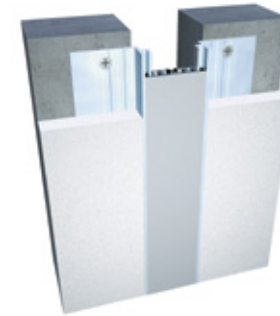

- Recessed mount frame for minimal sightline.
- Dual durometer seal provides secure fit and optimal flexibility.
- Adaptable to any 5/8" (16mm) wall and ceiling finish, including drywall, plaster and tile.
- Snap-fit design allows for easy on-site assembly.

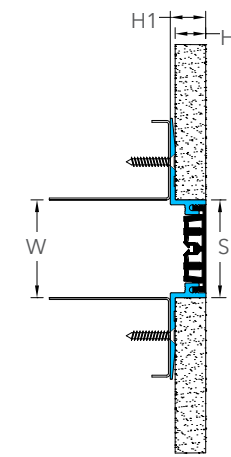

A07 Wall/Wall Ceiling/Ceiling (2" (51mm) system shown)

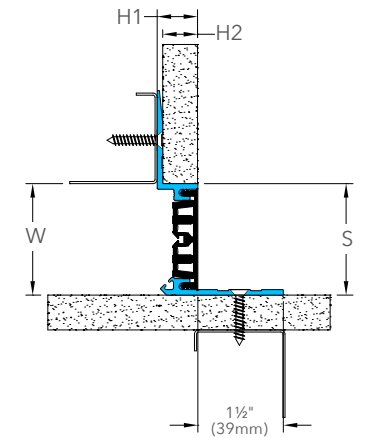

A09 Wall/Corner Wall/Ceiling (3" (75mm) system shown)

Application	System	W		H1		H2		S		B		Movement +/-			
		Joint Width		Frame Height 1		Height 2		Sightline		Blockout		Horizontal		Vertical	
		US	mm	US	mm	US	mm	US	mm	US	mm	US	mm	US	mm
Wall to Wall Ceiling to Ceiling	101-A07-025	1"	25	3/4"	19	5/8"	16	1"	25	*	*	1/4"	6	1/4"	6
	101-A07-038	1 1/2"	38	3/4"	19	5/8"	16	1 7/16"	36	*	*	3/8"	10	3/8"	10
	101-A07-050	2"	51	3/4"	19	5/8"	16	1 7/8"	47	*	*	1/2"	13	1/2"	13
	101-A07-075	3"	76	3/4"	19	5/8"	16	2 7/8"	73	*	*	3/4"	19	3/4"	19
Wall to Corner Wall to Ceiling	101-A09-025	1"	25	3/4"	19	5/8"	16	1"	25	*	*	1/4"	6	1/4"	6
	101-A09-038	1 1/2"	38	3/4"	19	5/8"	16	1 7/16"	36	*	*	3/8"	10	3/8"	10
	101-A09-050	2"	51	3/4"	19	5/8"	16	1 7/8"	47	*	*	1/2"	13	1/2"	13
	101-A09-075	3"	76	3/4"	19	5/8"	16	2 7/8"	73	*	*	3/4"	19	3/4"	19

114 Series



- Frame allows for finish with joint compound or wall covering to minimize sightline.

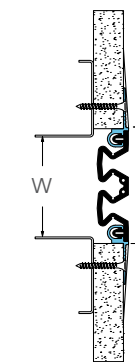

A07 Wall/Wall Ceiling/Ceiling (3" (75mm) system shown)

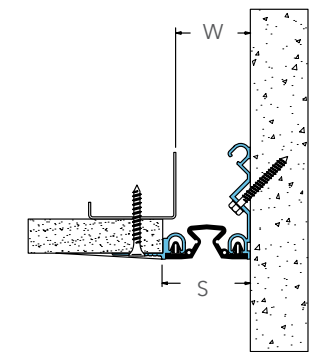

A09 Wall/Corner Wall/Ceiling (2" (51mm) system shown)

Application	System	W		H1		H2		S		B		Movement +/-			
		Joint Width		Frame Height 1		Height 2		Sightline		Blockout		Horizontal		Vertical	
		US	mm	US	mm	US	mm	US	mm	US	mm	US	mm	US	mm
Wall to Wall Ceiling to Ceiling	114-A07-050	2"	51	*	*	*	*	2 1/8"	54	*	*	1"	25	1"	25
	114-A07-075	3"	76	*	*	*	*	3 1/16"	78	*	*	1 1/2"	38	1 1/2"	38
	114-A07-100	4"	102	*	*	*	*	4 1/8"	105	*	*	2"	51	2"	51
	114-A07-150	6"	152	*	*	*	*	6 1/8"	156	*	*	3"	76	3"	76
Wall to Corner Wall to Ceiling	114-A09-050	2"	51	*	*	*	*	2"	51	*	*	1"	25	1"	25
	114-A09-075	3"	76	*	*	*	*	3"	76	*	*	1 1/2"	38	1 1/2"	38
	114-A09-100	4"	102	*	*	*	*	4"	102	*	*	2"	51	2"	51
	114-A09-150	6"	152	*	*	*	*	6"	152	*	*	3"	76	3"	76

Single Seal Systems

% of Movement ± 50% - 100% | Joint Width 2" (50mm) - 24" (600mm)

Pleated Santoprene™ Seal design allows for fluid, thermal and seismic movement during joint expansion, contraction, lateral and out-of-plane movement.



- Standard and custom seal colors available.

611 Series - Flush Mount



A09 Wall/Corner Wall/Ceiling
(4" (102mm) system shown)

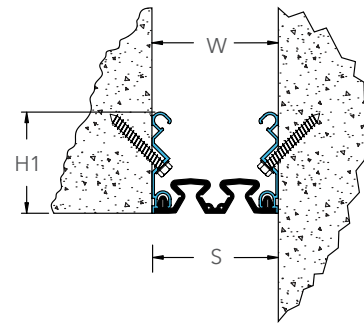

- Allows for expansion/contraction during thermal movement.
- Sightline reduced to width of flexible seal.
- Seals available in standard and custom colors.

Application	System	W		H1		H2		S		B		Movement +/-			
		Joint Width		Frame Height 1		Height 2		Sightline		Blockout		Horizontal		Vertical	
		US	mm	US	mm	US	mm	US	mm	US	mm	US	mm	US	mm
Wall/Wall Ceiling/Ceiling	611-A07-050	2"	51	2 3/8"	60	*	*	2"	51	*	*	1"	25	1"	25
	611-A07-075	3"	76	2 3/8"	60	*	*	3"	76	*	*	1 1/2"	38	1 1/2"	38
	611-A07-100	4"	102	2 3/8"	60	*	*	4"	102	*	*	2"	51	2"	51
	611-A07-125	5"	127	2 3/8"	60	*	*	5"	127	*	*	2 1/2"	63	2 1/2"	63
	611-A07-150	6"	152	2 3/8"	60	*	*	6"	152	*	*	3"	76	3"	76
Wall/Corner Wall/Ceiling	611-A09-050	2"	51	2 3/8"	60	*	*	2"	51	*	*	1"	25	1"	25
	611-A09-075	3"	76	2 3/8"	60	*	*	3"	76	*	*	1 1/2"	38	1 1/2"	38
	611-A09-100	4"	102	2 3/8"	60	*	*	4"	102	*	*	2"	51	2"	51
	611-A09-125	5"	127	2 3/8"	60	*	*	5"	127	*	*	2 1/2"	63	2 1/2"	63
	611-A09-150	6"	152	2 3/8"	60	*	*	6"	152	*	*	3"	76	3"	76

612 Series - Flush Mount



A09 Wall/Corner Wall/Ceiling
(10" (250mm) system shown)

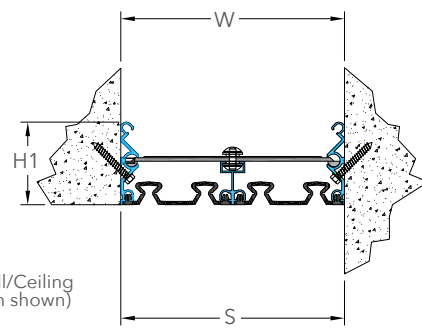

- Industry-unique Santoprene™ Seal design allows for fluid seismic movement during joint expansion and contraction.
- Field heat-weldable Santoprene seals for weather-tight seams and crisp transitions.
- Seal walls are among the thickest in the industry allowing our product to be used in soffits and corridor ceilings with no sagging.

Application	System	W		H1		H2		S		B		Movement +/-			
		Joint Width		Frame Height 1		Height 2		Sightline		Blockout		Horizontal		Vertical	
		US	mm	US	mm	US	mm	US	mm	US	mm	US	mm	US	mm
Wall to Wall	612-A07-200	8"	200	3"	75	*	*	8"	200	*	*	4"	102	4"	102
	612-A07-250	10"	250	3"	75	*	*	10"	250	*	*	5"	127	5"	127
	612-A07-300	12"	300	3"	75	*	*	12"	300	*	*	6"	152	6"	152
	612-A07-450	18"	450	3"	75	*	*	18"	450	*	*	9"	229	9"	229
	612-A07-600	24"	600	3"	75	*	*	24"	600	*	*	12"	305	12"	305
Wall to Corner	612-A09-200	8"	200	3"	75	*	*	8"	200	*	*	4"	102	4"	102
	612-A09-250	10"	250	3"	75	*	*	10"	250	*	*	5"	127	5"	127
	612-A09-300	12"	300	3"	75	*	*	12"	300	*	*	6"	152	6"	152
	612-A09-450	18"	450	3"	75	*	*	18"	450	*	*	9"	229	9"	229
	612-A09-600	24"	600	3"	75	*	*	24"	600	*	*	12"	305	12"	305

Larger sizes available.

Acoustical Ceiling Systems

Pleated Santoprene™ Seal design allows for fluid, thermal and seismic movement during joint expansion, contraction, lateral and out-of-plane movement.

- Standard and custom seal colors available.

115 Series - Acoustical Ceiling

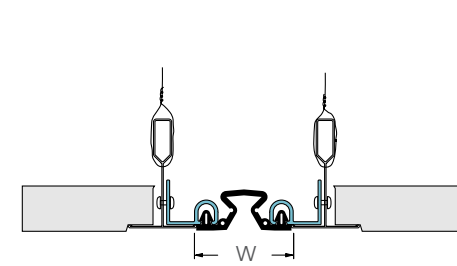
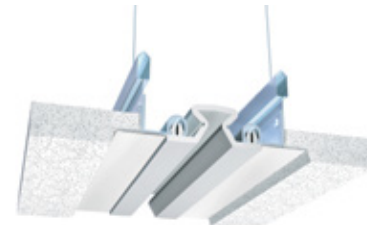

A24 Ceiling/Ceiling
(2" (51mm) system shown)

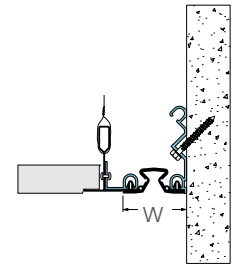

A18 Wall/Ceiling
(2" (51mm) system shown)

- Frame pop rivets to T-Bar profile in suspended ceiling system.
- Seal design allows for seismic movement.

Application	System	W		H1		H2		S		B		Movement +/-			
		Joint Width		Frame Height 1		Height 2		Sightline		Blockout		Horizontal		Vertical	
		US	mm	US	mm	US	mm	US	mm	US	mm	US	mm	US	mm
Ceiling/Ceiling	115-A24-050	2"	51	*	*	*	*	2"	51	*	*	1"	25	1"	25
	115-A24-075	3"	76	*	*	*	*	3"	76	*	*	1 1/2"	38	1 1/2"	38
	115-A24-100	4"	102	*	*	*	*	4"	102	*	*	2"	51	2"	51
	115-A24-125	5"	127	*	*	*	*	5"	127	*	*	2 1/2"	64	2 1/2"	64
	115-A24-150	6"	152	*	*	*	*	6"	152	*	*	3"	76	3"	76
Wall/Ceiling	115-A18-050	2"	51	*	*	*	*	2"	51	*	*	1"	25	1"	25
	115-A18-075	3"	76	*	*	*	*	3"	76	*	*	1 1/2"	38	1 1/2"	38
	115-A18-100	4"	102	*	*	*	*	4"	102	*	*	2"	51	2"	51
	115-A18-125	5"	127	*	*	*	*	5"	127	*	*	2 1/2"	64	2 1/2"	64
	115-A18-150	6"	152	*	*	*	*	6"	152	*	*	3"	76	3"	76

821 Series - Acoustical Ceiling

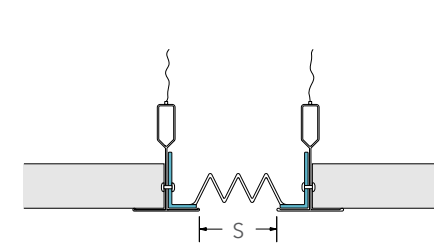
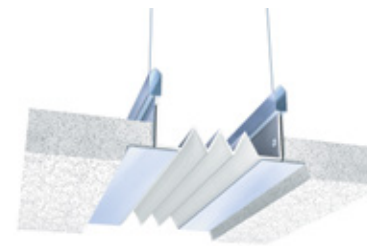

V24 Ceiling/Ceiling
(2" (51mm) system shown)

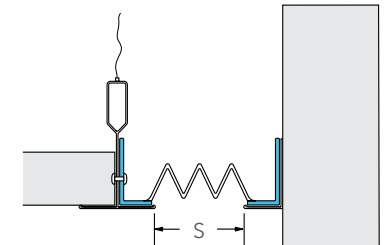

V23 Ceiling/Wall
(2" (51mm) system shown)

- Pop-rivet design allows for easy on-site assembly.
- Co-extruded pleated vinyl allows fluid movement.

Application	System	W		H1		H2		S		B		Movement +/-			
		Joint Width		Frame Height 1		Height 2		Sightline		Blockout		Horizontal		Vertical	
		US	mm	US	mm	US	mm	US	mm	US	mm	US	mm	US	mm
Wall to Wall Ceiling to Ceiling	821-V24-025	1"	25	*	*	*	*	1"	25	*	*	1/2"	13	1/2"	13
	821-V24-050	2"	51	*	*	*	*	2"	51	*	*	1"	25	1"	25
	821-V23-025	1"	25	*	*	*	*	1"	25	*	*	1/2"	13	1/2"	13
	821-V23-050	2"	51	*	*	*	*	2"	51	*	*	1"	25	1"	25

Standard color bright white.

Dual Seal Systems

% of Movement ± 50% | Joint Width 2" (50mm) - 18" (450mm)

Accommodates large joint widths with narrow sightlines for minimal aesthetic interruption.

- Center bar and compression spring assembly correctly reposition pan after seismic movement.
- Seal barbs provide secure engagement in frame, making installation easier.
- Face of seal resists sagging and remains flat in ceiling conditions.
- Field heat-weldable Santoprene™ Seals for weather-tight transitions.
- Standard and custom seal colors available.



221 Series - Aluminum Plate

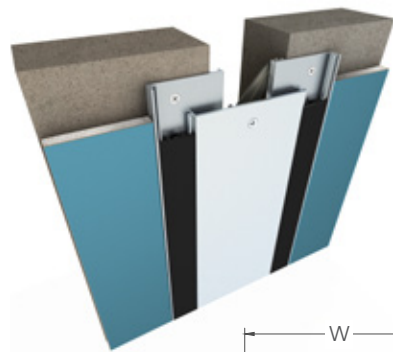

- Intended for use on smaller joint sizes where durability is required.
- Easy installation and maintenance.
- Anodized finish available.
- System can be painted in the field to match adjacent walls.

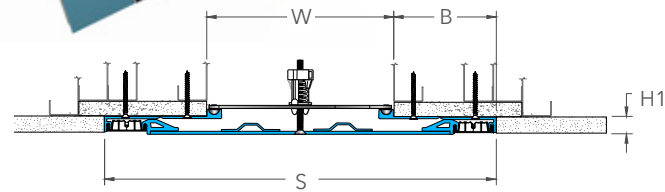

A07 Wall/Wall Ceiling/Ceiling
(6" (150mm) system shown)

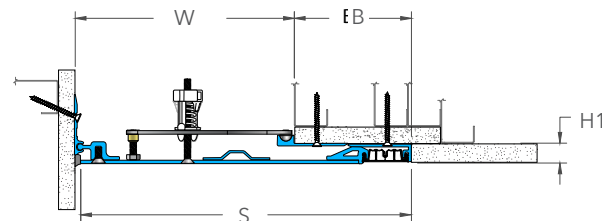

A09 Wall/Corner Wall/Ceiling
(6" (150mm) system shown)

Application	System	W		H1		S		B		Movement +/-			
		Joint Width		Frame Height 1		Sightline		Blockout		Horizontal		Vertical	
		US	mm	US	mm	US	mm	US	mm	US	mm	US	mm
Floor to Floor	221-A07-050	2"	51	5/8"	16	5"	124	1 1/2"	13	1"	25	1"	25
	221-A07-075	3"	76	5/8"	16	8 3/16"	212	2 3/4"	70	1 1/2"	38	1 1/2"	38
	221-A07-100	4"	102	5/8"	16	9 7/16"	238	2 3/4"	70	2"	51	2"	51
	221-A07-150	6"	152	5/8"	16	11 7/16"	290	2 3/4"	70	3"	75	3"	75
	221-A07-200	8"	203	5/8"	16	16 1/16"	424	4 3/8"	110	4"	102	4"	102
	221-A07-250	10"	254	5/8"	16	18 1/16"	481	4 1/2"	114	5"	125	5"	125
	221-A07-300	12"	305	5/8"	16	21 1/16"	557	4 1/16"	114	6"	152	6"	152
	221-A07-450	18"	457	5/8"	16	30 1/16"	786	6 3/16"	164	9"	228	9"	228
Floor to Wall	221-A09-050	2"	51	5/8"	16	3 1/2"	89	1 1/2"	13	1/2"	13	1/2"	13
	221-A09-075L	3"	76	5/8"	16	5 1/16"	145	2 3/4"	70	3/4"	19	3/4"	19
	221-A09-100	4"	102	5/8"	16	6 1/16"	171	2 3/4"	70	1"	25	1"	25
	221-A09-150L	6"	152	5/8"	16	8 1/16"	221	2 3/4"	70	1 1/2"	38	1 1/2"	38
	221-A09-200L	8"	200	5/8"	16	12 3/8"	314	4 3/8"	110	2"	51	2"	51
	221-A09-250L	10"	250	5/8"	16	14 7/16"	364	4 1/2"	114	2 1/2"	64	2 1/2"	64
	221-A09-300L	12"	300	5/8"	16	16 1/16"	457	4 1/16"	114	3"	76	3"	76
	221-A09-450L	18"	450	5/8"	16	24 1/16"	648	6 3/16"	164	4 1/2"	114	4 1/2"	114

223 Series - Drywall

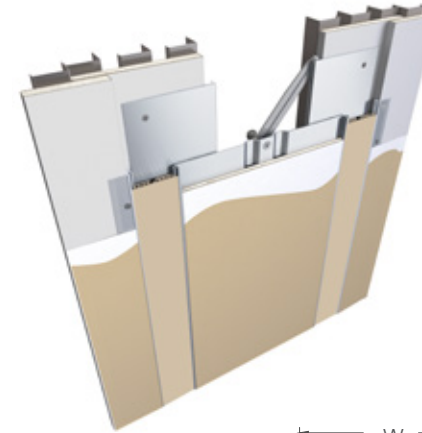

- Flat seal allows for 25% thermal movement prior to engaging center bar spring which allows for the full 50% movement.
- 3/8" (10mm) drywall within center pan cover to be painted or wall covered to reduce sightline.
- Intended for use on joints with both thermal and seismic capable needs.

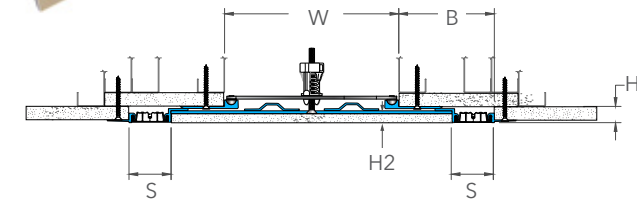

A07 Wall/Wall Ceiling/Ceiling
(8" (200mm) system shown)

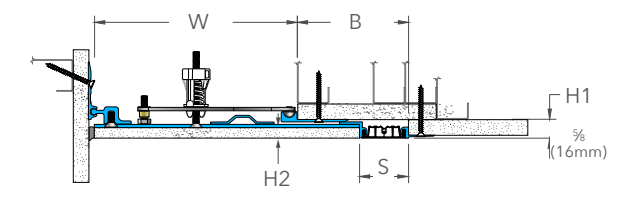

A09 Wall/Corner Wall/Ceiling
(8" (200mm) system shown)

Application	System	W		H1		H2		S		B		Movement +/-			
		Joint Width		Frame Height 1		Height 2		Sightline		Blockout		Horizontal		Vertical	
		US	mm	US	mm	US	mm	US	mm	US	mm	US	mm	US	mm
Floor to Floor	223-A01-050	2"	51	5/8"	16	3/8"	10	4"	102	1 1/2"	13	1"	25	1"	25
	223-A01-075	3"	76	5/8"	16	3/8"	10	4"	102	2 3/4"	70	1 1/2"	38	1 1/2"	38
	223-A01-100	4"	102	5/8"	16	3/8"	10	4"	102	2 3/4"	70	2"	51	2"	51
	223-A01-150	6"	152	5/8"	16	3/8"	10	4"	102	2 3/4"	70	3"	75	3"	75
	223-A01-200	8"	203	5/8"	16	3/8"	10	4"	102	4 3/8"	110	4"	102	4"	102
	223-A01-250	10"	254	5/8"	16	3/8"	10	4"	102	4 1/2"	114	5"	125	5"	125
	223-A01-300	12"	305	5/8"	16	3/8"	10	4"	102	4 15/16"	114	6"	152	6"	152
	223-A01-450	18"	457	5/8"	16	3/8"	10	4"	102	6 7/16"	164	9"	228	9"	228
Floor to Wall	223-A02-050	2"	51	5/8"	16	3/8"	10	2"	50	1 1/2"	13	1"	25	1"	25
	223-A02-075L	3"	76	5/8"	16	3/8"	10	2"	50	2 3/4"	70	3/4"	19	3/4"	19
	223-A02-100	4"	102	5/8"	16	3/8"	10	2"	50	2 3/4"	70	1"	25	1"	25
	223-A02-150L	6"	152	5/8"	16	3/8"	10	2"	50	2 3/4"	70	1 1/2"	38	1 1/2"	38
	223-A02-200L	8"	200	5/8"	16	3/8"	10	2"	50	4 3/8"	110	2"	51	2"	51
	223-A02-250L	10"	250	5/8"	16	3/8"	10	2"	50	4 1/2"	114	2 1/2"	64	2 1/2"	64
	223-A02-300L	12"	300	5/8"	16	3/8"	10	2"	50	4 15/16"	114	3"	76	3"	76
	223-A02-450L	18"	450	5/8"	16	3/8"	10	2"	50	6 7/19"	164	4 1/2"	114	4 1/2"	114



→ Rooms A150 - 161
Lift to Ground

ChristChurch, Justice + Emergency Services Precinct | Christchurch, New Zealand
353 Wall + Ceiling System, 501 Pan Floor System

Lateral Shear Series

353/355 Series

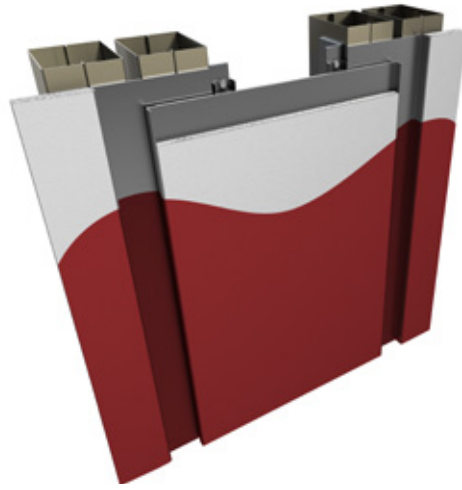

- Flush or surface mounted pan cover plate system for wall and ceiling expansion joint applications.
- Offered in both: Recessed mount (353 series) and surface (355 series)
- System accommodates lateral shear movement.
- Ranges from small to extremely wide joint conditions, while maintaining a minimal sightline impact to the interior environment.
- Pan and frame wings can be anodized, or pre-primed to be painted in field.
- Pan options include:
 - Flush metal cover plate (pre-primed optional)
 - Gypsum board infill
 - Ceramic tile infill
- No exposed hardware for security and cleaning purposes.
- System can be customized for $\pm 100\%$ lateral movement

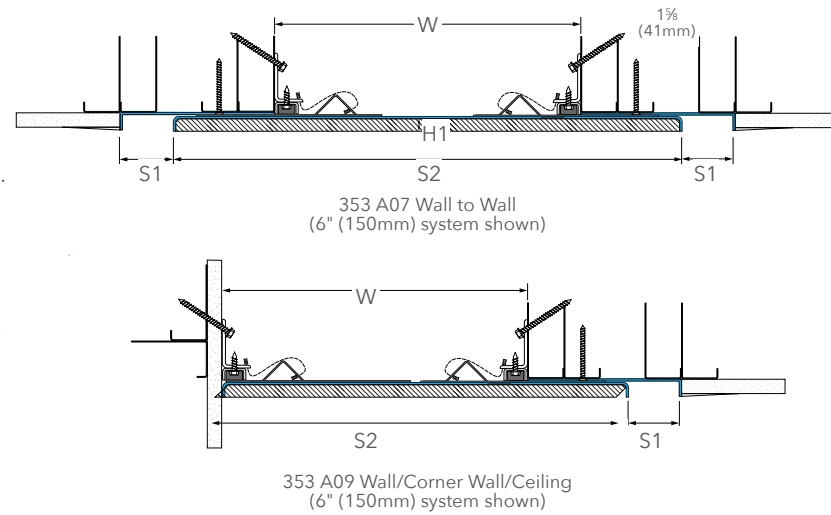

US Patent Pending

Application	System	W		H1		S		B		Seismic Movement +/-			
		Joint Width		Pan Height		Sightline		Blockout		Horizontal		Vertical	
		US	mm	US	mm	US	mm	US	mm	US	mm	US	mm
Wall to Wall	353-A07/A24-150	6"	152	1/2"	13	1 1/4"	32	3 5/8"	91	3"	76	3"	76
	353-A07/A24-200	8"	203	1/2"	13	1 1/4"	32	4"	102	4"	102	4"	102
	353-A07/A24-250	10"	254	1/2"	13	1 1/4"	32	4 5/8"	116	5"	127	5"	127
	353-A07/A24-300	12"	305	1/2"	13	1 1/4"	32	5 1/8"	130	6"	152	6"	152
	353-A07/A24-400	16"	406	1/2"	13	1 1/4"	32	4 5/8"	116	8"	203	8"	203
	353-A07/A24-450	18"	457	1/2"	13	1 1/4"	32	5 7/8"	123	9"	228	9"	228
Wall To Corner	353-A07/A24-600	24"	610	1/2"	13	1 1/4"	32	4 5/8"	117	12"	305	12"	305
	353-A09/A18-150	6"	152	1/2"	13	1 1/4"	32	3 5/8"	91	3"	76	3"	76
	353-A09/A18-200	8"	203	1/2"	13	1 1/4"	32	4"	102	4"	102	4"	102
	353-A09/A18-250	10"	254	1/2"	13	1 1/4"	32	5"	127	5"	127	5"	127
	353-A09/A18-300	12"	305	1/2"	13	1 1/4"	32	5 1/8"	130	6"	152	6"	152
	353-A09/A18-400	16"	406	1/2"	13	1 1/4"	32	4 5/8"	117	8"	203	8"	203
	353-A09/A18-450	18"	457	1/2"	13	1 1/4"	32	6"	152	9"	228	9"	228
	353-A09/A18-600	24"	610	1/2"	13	1 1/4"	32	4 5/8"	117	12"	305	12"	305

Larger sizes available. Vertical movement details available upon request.



- A** Cover panel disengages during seismic events; while arrest cables ensures the panel stays close to the wall and ceiling, ensuring egress routes to be maintained and clear.
- B** Heavy duty security magnet system allows for generous daily thermal movement and lateral shear without disengagement from the wall.
- C** System's sightline can be custom modified to match floor, system coverplate widths. (upon request)

Glide Plate + General Purpose

% of Movement ± 50% | Joint Width 1" (25mm) - 12" (300mm)

A clear anodized finish is standard on these systems. They provide a tough, durable finish that is easy to clean.

- Systems expertly engineered to hold up interior and exterior wall applications.
- Provide crisp lines and shadows for a clean, finished look.

300 Series - Glide Plate



- 5/8" recessed frame designed for inset into drywall installations (can be surface mounted as well).
- Snap-fit cover designed for easy on-site assembly, no exposed fasteners make system ideal for public/high abuse conditions.
- Clear anodized finish.
- Custom angles available.
- Available with high quality primer for field painting.

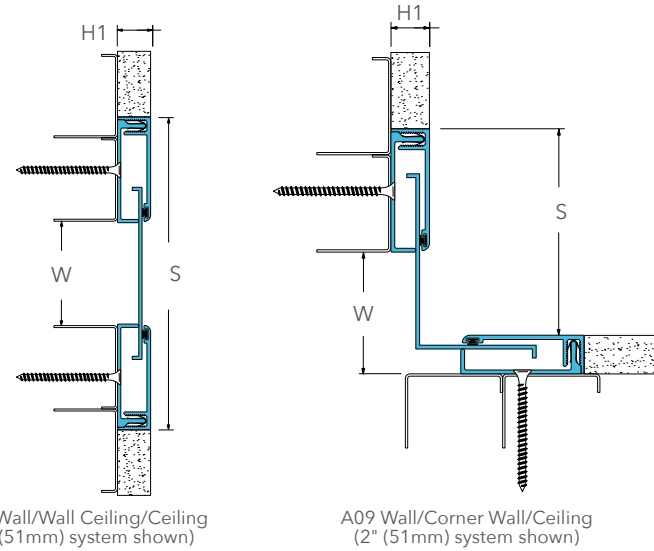

Application	System	W		H1		H2		S		B		Movement +/-			
		Joint Width		Frame Height 1		Height 2		Sightline		Blockout		Horizontal		Vertical	
		US	mm	US	mm	US	mm	US	mm	US	mm	US	mm	US	mm
Wall to Wall Ceiling to Ceiling	300-A07-025	1"	25	5/8"	16	*	*	5"	127	2"	51	1/2"	13	1/4"	6
	300-A07-050	2"	51	5/8"	16	*	*	6"	152	2"	51	1"	25	1/2"	13
	300-A07-075	3"	76	5/8"	16	*	*	9"	229	3"	76	1 1/2"	38	3/4"	19
	300-A07-100	4"	102	5/8"	16	*	*	10"	254	3"	76	2"	51	1"	25
	300-A07-150	6"	152	5/8"	16	*	*	14"	356	4"	102	3"	76	1 1/2"	38
	300-A07-200	8"	203	5/8"	16	*	*	18"	458	5"	127	4"	102	2"	51
	300-A07-250	10"	254	5/8"	16	*	*	24"	610	7"	178	5"	127	2 1/2"	64
Wall to Corner Wall to Ceiling	300-A07-300	12"	305	5/8"	16	*	*	26"	661	7"	178	6"	152	3"	76
	300-A09-025	1"	25	5/8"	16	*	*	4 5/8"	117	2"	51	1/4"	6	3/4"	19
	300-A09-050	2"	51	5/8"	16	*	*	6 1/8"	156	2"	51	1/2"	13	3/4"	19
	300-A09-075	3"	76	5/8"	16	*	*	8 1/8"	206	3"	76	3/4"	19	7/8"	22
	300-A09-100	4"	102	5/8"	16	*	*	9 1/8"	232	3"	76	1"	25	1"	25
	300-A09-150	6"	152	5/8"	16	*	*	12 1/8"	308	4"	102	1 1/2"	38	1 1/4"	32
	300-A09-200	8"	203	5/8"	16	*	*	15 1/8"	384	5"	127	2"	51	1 1/2"	38
300-A09-250	10"	254	5/8"	16	*	*	21 5/8"	549	7"	178	2 1/2"	64	2"	51	
300-A09-300	12"	305	5/8"	16	*	*	23 5/8"	600	7"	178	3"	76	2 1/2"	64	

318 Series - Glide Plate



- Specifically designed for vinyl wall covering, although can be utilized in conjunction with other finishes as well.
- Single narrow sightline preferred by interior designers.

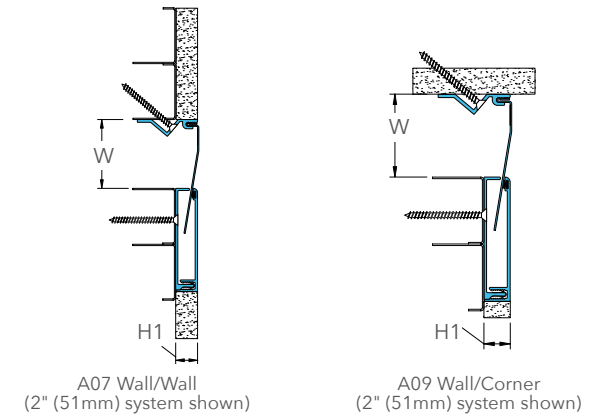

Application	System	W		H1		S		B		Movement +/-			
		Joint Width		Frame Height 1		Sightline		Blockout		Horizontal		Vertical	
		US	mm	US	mm	US	mm	US	mm	US	mm	US	mm
Wall to Wall	318-A07-050	2"	51	5/8"	16	1/8"	3	*	*	1"	25	1/2"	13
	318-A07-075	3"	76	5/8"	16	1/8"	3	*	*	1 1/2"	38	3/4"	19
	318-A07-100	4"	102	5/8"	16	1/8"	3	*	*	2"	51	1"	25
Wall to Corner	318-A09-050	2"	51	5/8"	16	1/8"	3	*	*	1"	25	1/2"	13
	318-A09-075	3"	76	5/8"	16	1/8"	3	*	*	1 1/2"	38	3/4"	19
	318-A09-100	4"	102	5/8"	16	1/8"	3	*	*	2"	51	1"	25

491 Series - Surface Mount Frame

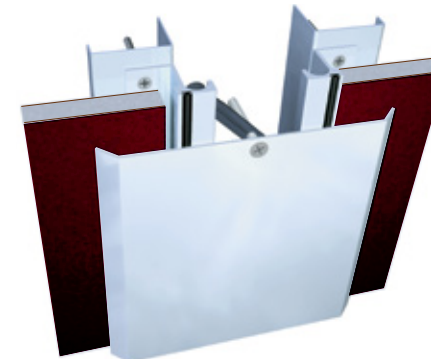

- Adaptable to many wall finishes, including drywall and tile.
- 491 systems designed for renovations and surface mount installations, lowering on-site installation costs.

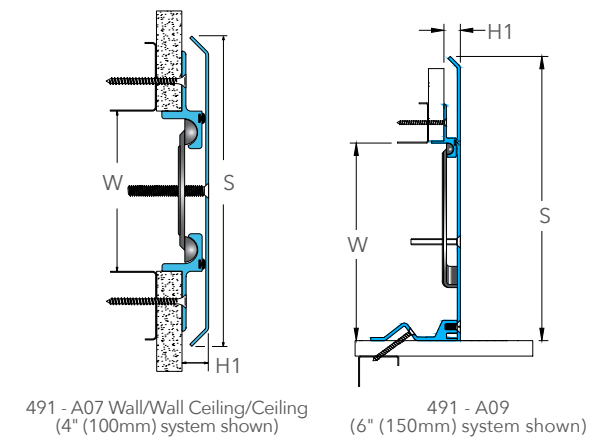

Application	System	W		H1		H2		S		B		Movement +/-			
		Joint Width		Frame Height 1		Height 2		Sightline		Blockout		Horizontal		Vertical	
		US	mm	US	mm	US	mm	US	mm	US	mm	US	mm	US	mm
Wall/Wall Ceiling/Ceiling	491-A07-050	2"	51	5/8"	15	*	*	5 3/4"	146	*	*	9/16"	14	1"	25
	491-A07-075	3"	76	5/8"	15	*	*	6 3/4"	171	*	*	1 1/2"	38	1 1/2"	38
	491-A07-100	4"	102	5/8"	15	*	*	7 3/4"	197	*	*	2"	51	2"	51
	491-A07-150	6"	152	5/8"	15	*	*	9 3/4"	248	*	*	2 1/2"	64	3"	76
	491-A07-200	8"	203	5/8"	15	*	*	13"	330	*	*	4"	102	4"	102
	491-A07-250	10"	254	5/8"	15	*	*	16"	406	*	*	5"	127	5"	127
	491-A07-300	12"	305	5/8"	15	*	*	19 1/16"	484	*	*	6"	152	6"	152
Wall/Corner Wall/Ceiling	491-A09-050	2"	51	5/8"	15	*	*	3 7/8"	98	*	*	1/2"	13	1/2"	13
	491-A09-075	3"	76	5/8"	15	*	*	4 7/8"	124	*	*	3/4"	19	3/4"	19
	491-A09-100	4"	102	5/8"	15	*	*	5 7/8"	149	*	*	1"	25	1"	25
	491-A09-150	6"	152	5/8"	15	*	*	7 7/8"	200	*	*	1 1/2"	38	1 1/2"	38
	491-A09-200	8"	203	5/8"	15	*	*	10 1/2"	267	*	*	2"	51	2"	51
	491-A09-250	10"	254	5/8"	15	*	*	13"	330	*	*	2 1/2"	64	2 1/2"	64
	491-A09-300	12"	305	5/8"	15	*	*	15 1/2"	394	*	*	3"	76	3"	76

Larger sizes available.

Surface Mounted Cover Plate

% of Movement ± 50% | Joint Width 1" (25mm) - 4" (100mm)

Our joint covers are designed to fit with a variety of wall and ceiling materials for minimal aesthetic interruption. These cost-effective solutions were engineered for the many conditions encountered within interior walls.

811 Series - Variable Degree Cover

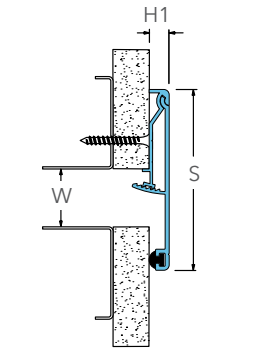
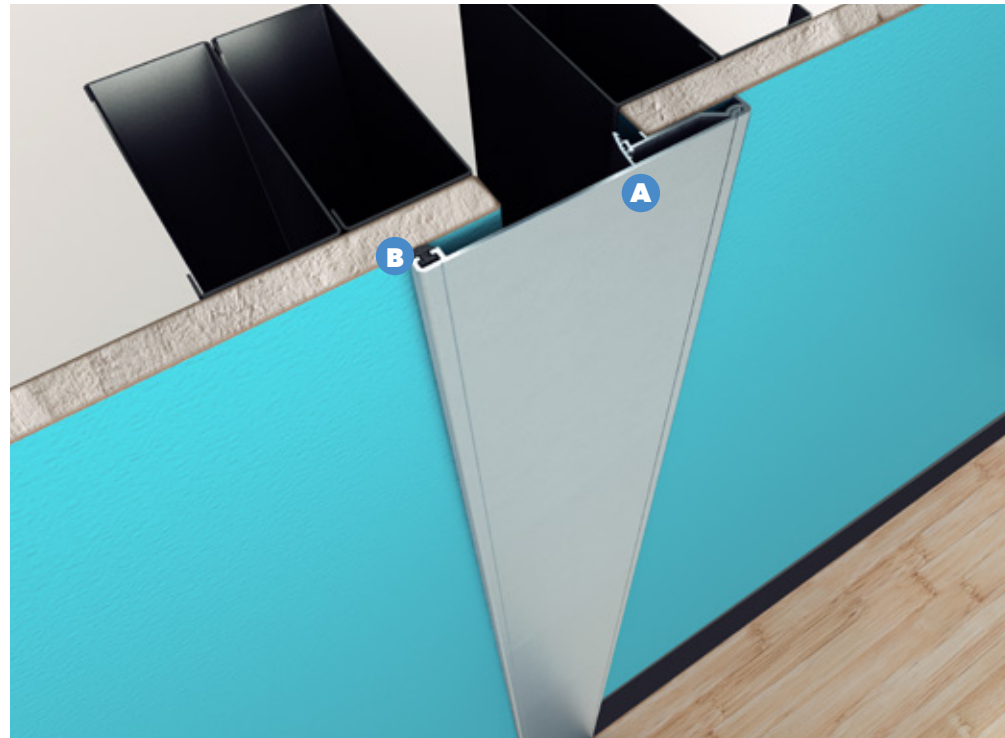

A07 Wall/Wall Ceiling/Ceiling (1" (25mm) system shown)

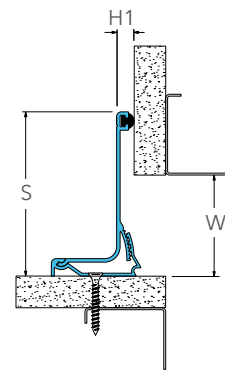

A09 Wall/Corner Wall/Ceiling (2" (51mm) system shown)

- Economical solution for retrofit/surface mount installations.
- Snap-fit design for easy on-site assembly.
- Clear anodized finish standard.
- Available with high quality primer for field painting or a stainless steel veneer.

- A** Unique ratcheted design accommodates uneven or odd angle wall conditions.
- B** Integrated seal to prevent marring substrate.

Application	System	W		H1		H2		S		B		Movement +/-			
		Joint Width		Frame Height 1		Height 2		Sightline		Blockout		Horizontal		Vertical	
		US	mm	US	mm	US	mm	US	mm	US	mm	US	mm	US	mm
Wall/Wall Ceiling/Ceiling	811-A07-025	1"	25	3/8"	9	*	*	3 1/8"	79	*	*	1/2"	13	*	*
	811-A07-050	2"	51	3/8"	9	*	*	4 5/8"	118	*	*	1"	25	*	*
	811-A07-075	3"	76	3/8"	9	*	*	6 1/8"	156	*	*	1 1/2"	38	*	*
	811-A07-100	4"	102	3/8"	9	*	*	7 5/8"	194	*	*	2"	51	*	*
Wall/Corner Wall/Ceiling	811-A09-025	1"	25	3/8"	9	*	*	1 3/4"	44	*	*	1/2"	13	*	*
	811-A09-050	2"	51	3/8"	9	*	*	3 1/4"	83	*	*	1"	25	*	*
	811-A09-075	3"	76	3/8"	9	*	*	4 3/4"	121	*	*	1 1/2"	38	*	*
	811-A09-100	4"	102	3/8"	9	*	*	6 1/4"	159	*	*	2"	51	*	*

[Watch the video on our YouTube page.](#)





104 Series

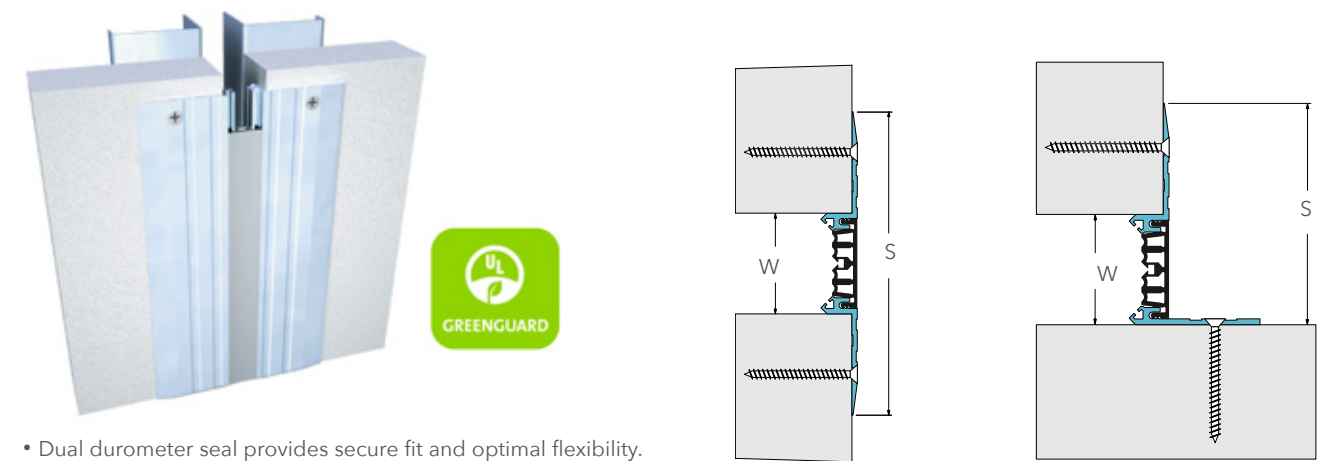

- Dual durometer seal provides secure fit and optimal flexibility.
- Designed for renovation and surface mount installations.
- Clear anodized finish standard.
- Adaptable to any wall finish.

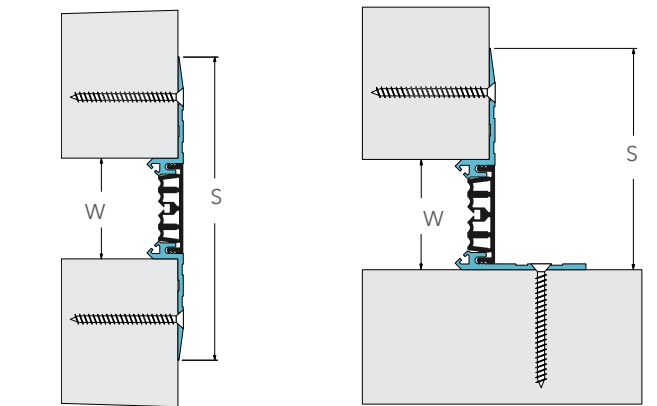

Application	System	W		H1		H2		S		B		Movement +/-			
		Joint Width		Frame Height 1		Height 2		Sightline		Blockout		Horizontal		Vertical	
		US	mm	US	mm	US	mm	US	mm	US	mm	US	mm	US	mm
Wall to Wall Ceiling to Ceiling	104-A07-025	1"	25	*	*	*	*	4 3/4"	121	*	*	1/4"	6	1/4"	6
	104-A07-038	1 1/2"	38	*	*	*	*	5 1/8"	130	*	*	3/8"	10	3/8"	10
	104-A07-050	2"	51	*	*	*	*	5 5/8"	143	*	*	1/2"	13	1/2"	13
	104-A07-075	3"	76	*	*	*	*	6 5/8"	168	*	*	3/4"	19	3/4"	19
Wall to Corner Wall to Ceiling	104-A09-025	1"	25	*	*	*	*	2 7/8"	73	*	*	1/4"	6	1/4"	6
	104-A09-038	1 1/2"	38	*	*	*	*	3 5/16"	84	*	*	3/8"	10	3/8"	10
	104-A09-050	2"	51	*	*	*	*	3 3/4"	95	*	*	1/2"	13	1/2"	13
	104-A09-075	3"	76	*	*	*	*	4 3/4"	121	*	*	3/4"	19	3/4"	19

801 Series

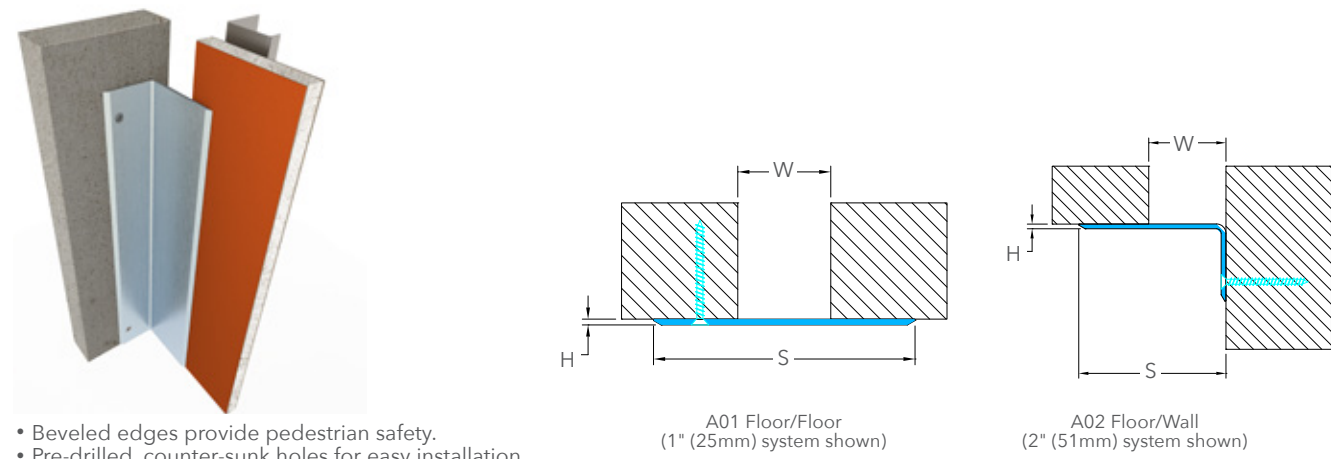

- Beveled edges provide pedestrian safety.
- Pre-drilled, counter-sunk holes for easy installation.
- Available in stainless steel and other custom finishes.
- Matching hardware included.

Application	System	W		H		S		Movement +/-			
		Joint Width		Frame Height		Sightline		Horizontal		Vertical	
		US	mm	US	mm	US	mm	US	mm	US	mm
Wall to Wall	801-A07-025	1"	25	1/8"	3	4 1/8"	105	1/2"	13	*	*
	801-A07-050	2"	51	1/8"	3	5 5/8"	143	1"	25	*	*
	801-A07-075	3"	76	1/4"	6	9 1/4"	235	1 1/2"	38	*	*
	801-A07-100	4"	102	1/4"	6	9 1/4"	235	2"	51	*	*
Wall to Corner	801-A09-025	1"	25	1/8"	3	2 9/16"	65	1/2"	13	*	*
	801-A09-050	2"	51	1/8"	3	3 15/16"	97	1"	25	*	*
	801-A09-075	3"	76	1/4"	6	7 7/16"	189	1 1/2"	38	*	*
	801-A09-100	4"	102	1/4"	6	7 7/16"	189	2"	51	*	*

Larger sizes available. Vertical movement details available upon request.

118 Series

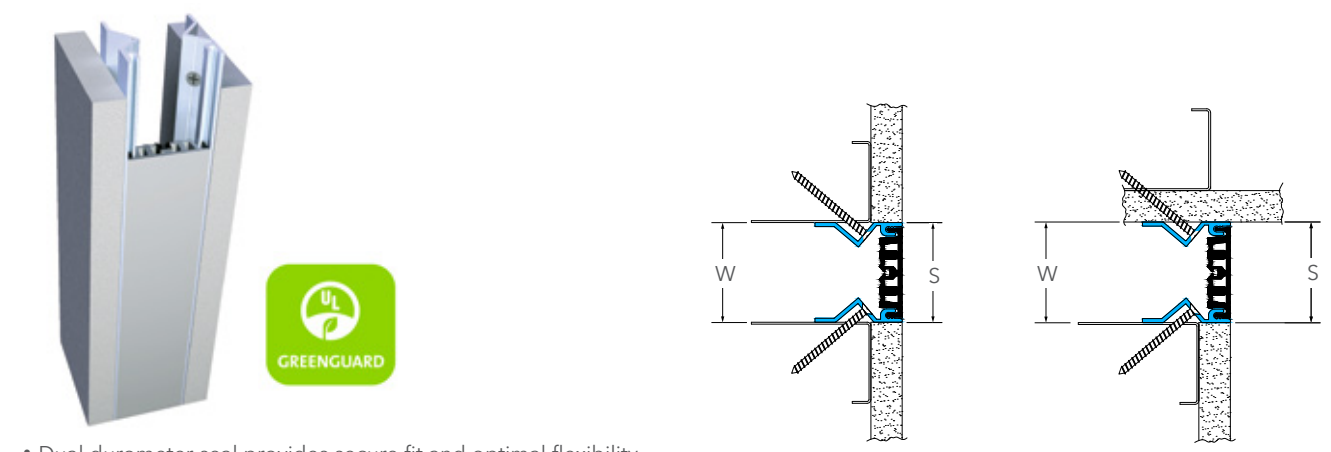

- Dual durometer seal provides secure fit and optimal flexibility.
- Flush mount frame reduces sightline.
- Adaptable to any wall finish.

Application	System	W		H1		H2		S		B		Movement +/-			
		Joint Width		Frame Height 1		Height 2		Sightline		Blockout		Horizontal		Vertical	
		US	mm	US	mm	US	mm	US	mm	US	mm	US	mm	US	mm
Wall to Wall	118-A07-050	2"	50	*	*	*	*	1 7/8"	47	*	*	1/2"	13	1/2"	13
	118-A07-075	3"	75	*	*	*	*	2 7/8"	73	*	*	3/4"	19	3/4"	19
Wall to Corner	118-A09-050	2"	50	*	*	*	*	1 7/8"	47	*	*	1/2"	13	1/2"	13
	118-A09-075	3"	75	*	*	*	*	2 7/8"	73	*	*	3/4"	19	3/4"	19

Recent Projects

The list below is a sample of projects we've completed across the globe. For more information or detailed project profiles, visit inpro.com/jointmaster.



MGM National Harbor
Oxon Hill, MD

Anchorage Museum Phase 2
Anchorage, AK

Weld County Courts
Greeley, CO

BCT-H Barracks Complex
Fort Carson, CO

LA Coroners Office
Los Angeles, CA

McCully District Park
Honolulu, HI

Richmond Masonic Temple
Richmond, VA

Lake Oswego Water Treatment Plant
Portland, OR

Yakama Nation Casino-Exteriors
Toppenish, WA

Cinemark Movie Theater
North Haven, CT

Kirkwood Public Library
Kirkwood, MO

Village of Palatine Police Department
Palatine, IL

Rock County Jail
Janesville, WI

Milwaukee Art Museum
Milwaukee, WI



World Trade Center
New York City, NY

OK State Fairgrounds Expo Center
Oklahoma City, OK

Jeanne Bellamah Comm Center
Albuquerque, NM

Cross Point Church
Oconomowoc, WI

River Spirit Casino
Tulsa, OK

Google Tech Corners Bldgs
Sunnyvale, CA

Boys & Girls Club @ Shoreline
Santa Cruz, CA

Pensacola Regional Airport
Pensacola, FL

Jackson Hole Airport Baggage Claim
Jackson Hole, WY

SDIA Rental Car
San Diego, CA

Lambert Airport Terminal 1 Baggage
St. Louis, MO

Delta Airlines Lobby / ATO Renovation Sea Tac
Airport
Seattle, WA

St. Mary's Hospital Century Project
Grand Junction, CO



Milwaukee Mitchell Airport
Milwaukee, WI

Las Vegas VA Hospital
Las Vegas, NV

SUMC Nuclear Medicine Dept
Stanford, CA

Rocky Mtn Hospital for Children
Denver, CO

Moab Regional Medical Center
Moab, UT

UNMH Clinical Neuroscience Center
Albuquerque, NM

Alaska Regional Hospital
Anchorage, AK

Community Hospital of Grand Junction
Grand Junction, CO

Rush University Medical Center
Chicago, IL

Hospital Expansion & Renovation
Laurium, MI

Biloxi VA Mental Health
Biloxi, VA

Jennie Sealy
Galveston, TX

Mercy Cancer Center
Joplin, MO

Cleveland Clinic
Abu Dhabi, UAE



Citrus Bowl
Orlando, FL

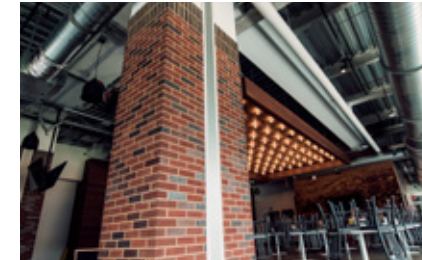

SunTrust Stadium
Atlanta, GA



College of San Mateo
San Mateo, CA



CLSB - OHSU Life Sciences
Portland, OR

Owensboro Medical Center
Owensboro, KY

Parkland Hospital
Dallas, TX

Abraham Lincoln High School
San Francisco, CA

Dufur School
Dufur, OR

Sierra Vista Middle School
La Puente, CA

Chemawa Indian School
Salem, OR

Jefferson Elementary School
West Allis, WI

BSU Student Union Transit Center
Boise, ID

Seattle University Fitness Center
Seattle, WA

Pima Community College
Tuscon, AZ

Purdue Honors College
West Lafayette, IN

Santa Clara Univ Phase 2 Student Residence
Santa Clara, CA

St. Louis University Residence Hall
St. Louis, MO



UW Platteville
Platteville, WI

Texas City High School
Texas City, TX

Waikiki Shopping Plaza
Honolulu, HI

Maui Lani Shopping Center
Wailuku, HI

Three Rivers Mall Regal Theater Connection
Kelso, WA

Harley Davidson of Scottsdale
Scottsdale, AZ

Rusnak MB Arcadia Mercedes-Benz
Arcadia, CA

Palos Verde Senior Living
Peoria, AZ

Oakmont Senior Housing
Windsor, CA

Forest park Middle School
Franklin, WI

Shinola Hotel
Detroit, MI

Wrigley Field renovations
Chicago, IL

Hamilton Sussex intermediate school
Sussex, WI

Austin Bergstrom International Airport (ABIA)
Austin, TX

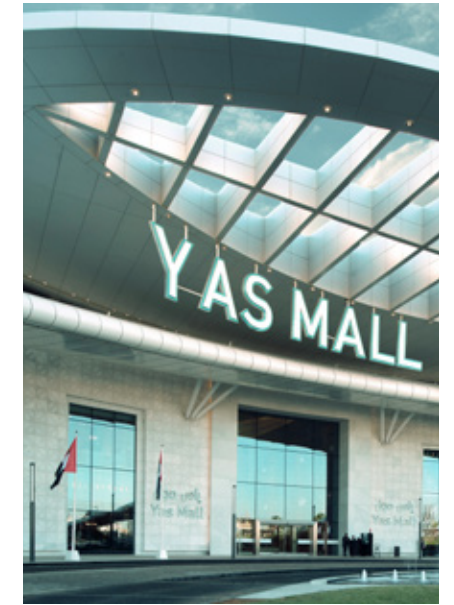

Yas Mall
Abu Dhabi, UAE

Silver Spot movie theater
Brookfield, WI

Salt Lake County Office Building and Parking
Structure
Salt Lake City, UT

The District at Milpitas
Milpitas, CA

Stanford at Redwood City

Tacoma Art Museum
Tacoma, WA

Santa Clara Square
Santa Clara, CA

AVA at Esterra Park
Redmond, WA

Jefferson Stadium Park Apartments
Anaheim, CA

UC San Diego Osler Parking
La Jolla, CA

Idaho National Lab
Idaho Falls, ID

ICD Brookfield Place
Dubai, UAE

Nshama Town Square Development
Dubai, UAE



obsessed with protecting buildings®

How they look. How they function.
And how they protect the health and safety
of the people who use them every day.

That's why we make hundreds of architectural
products all under one roof and work tirelessly to
make sure you and your buildings succeed.

Yeah, we are obsessed. But we wouldn't
have it any other way.

inpro.com

800.222.5556

World Headquarters
580 W18766 Apollo Drive
Muskego, WI 53150 USA

IPC® Door + Wall Protection
Ascend® Elevator Protection
Juniper® Commercial Window Treatments
Clickeze® Privacy Systems
Endurant® Washroom Systems
SignScape® Architectural Signage
JointMaster® Expansion Joint Systems

©2019 Inpro Corporation

